



PENNBARRY™

Moving Your Way

FUMEX

Upblast Roof Exhausters

TABLE OF CONTENTS

Introduction, Certifications & Listings	3
Features & Benefits	4
Options & Accessories	5
Motor Availability	8
Direct Drive Dimensional & Performance Data	10
Belt Drive Dimensional & Performance Data	13
Engineering Specifications	29



BULLETIN FX14

INTRODUCTION

Fumex Series of Centrifugal Fans

Fumex centrifugal fans are designed for medium to high pressure applications. They can be either roof or wall mounted. While suitable for general ventilation, Fumex fans are specifically designed to discharge contaminated or grease-laden air or fumes up and away from building surfaces. The optional “Fatrap” (UL762) restaurant grease exhaust configuration (see Fatrap Configuration) makes Fumex fans particularly suited for all food service applications and chemical fume hoods. The optional heat and smoke removal configuration (see Smoke Removal) makes Fumex fans particularly suited for heat and smoke control systems. The optional high wind construction makes Fumex Fans particularly suited for high wind hurricane zones. Fumex fans are available in a range of capacities.

Fumex fans feature a weather-resistant seamless spun aluminum housing which provides ample drainage and works in conjunction with a patented wheel design and deeply spun inlets to provide smooth quiet airflow through the ventilator. The centrifugal wheels are aluminum, non-overloading, backward inclined, robotically welded, and dynamically balanced.

Fumex Direct Drive Series

Model: FX (V/S/R/Q/Q1/Q2)

- Static pressure up to 1.5 in. wg.
- Flow capacity up to 4,489 CFM.
- Fatrap (FT) option available on sizes 13, 16, and 18.
- High Wind Construction (-HW) option available.

Fumex Standard Duty Belt Drive Series

Model: FX (B)

- Static pressure up to 2.5 in. wg.
- Flow capacity up to 21,511 CFM.
- Fatrap (FT) option available.
- Heat & Smoke Removal (-HS) option available.
- High Wind Construction (-HW) option available.

Fumex High Pressure Belt Drive Series

Model: FX (BH)

- Static pressure up to 4 in. wg.
- Flow capacity up to 9,920 CFM.
- Fatrap (FT) option available.
- Heat & Smoke Removal (-HS) option available.
- High Wind Construction (-HW) option available.

Fumex High Capacity Belt Drive Series

Model: FMX (B)

- Static pressure up to 1.5 in. wg.
- Flow capacity up to 25,035 CFM.



Belt Drive Fumex with Fatrap option (left) and Direct Drive Fumex (below).

CERTIFICATIONS & LISTINGS



Fumex Direct & Belt Drive Fans

PennBarry certifies that the Fumex direct drive and belt drive models FX, FXB, FXBH, and FXBHFT shown herein are licensed to bear the AMCA Seal. The ratings shown are based on tests and procedures performed in accordance with AMCA Publication 211 and Publication 311 and comply with the requirements of the AMCA Certified Ratings Program.



Fumex High Capacity Belt Drive Fans

PennBarry certifies that the Fumex belt drive model FMXB shown herein is licensed to bear the AMCA Seal. The ratings shown are based on tests and procedures performed in accordance with AMCA Publication 211 and comply with the requirements of the AMCA Certified Ratings Program.

UL and cUL Certification

Fumex fans carry the UL label, UL 705 (ZACT), File #E28413. Fumex fans with the “Fatrap” option are UL 762 (YZHW) listed under file #MH10684. Fumex fans with the heat and smoke removal option are UL listed under file #MH19473.



FEATURES & BENEFITS

Motor Selection

Both direct drive and belt drive models are available with a wide range of voltages and enclosures (see Motor Selection for a complete listing). Standard belt drive Open Drip Proof (ODP) ball bearing motors are selected using a conservative portion of the NEMA service factor. Standard direct drive ODP motors have Class B insulation and internal overload protection. Overload protection is available as an option on belt drive models. Each size is carefully engineered to match the motor to the wheel capacity.

Internal Wiring

All direct and belt drive models with ODP motors feature a polarized disconnect plug which is factory wired from the motor to the junction box. This provides a positive method of electric shut-off as required by most codes without requiring the traditional disconnect switch. (See Options & Accessories for optional NEMA wiring and disconnect devices.)

Sound Performance

Fumex units deliver outstanding air performance with minimal noise and have the lowest AMCA licensed sound performance in the industry.

Curb Caps (Base)

Curb caps for direct drive and standard duty belt drive models are available in galvanized steel (standard) or aluminum (optional). Curb caps for high capacity belt drive models are available only in aluminum. All curb caps have fully welded corners and are pre-punched to ensure a leak-tight and easy installation.

Forced Motor Cooling

Motors and drive components are located out of the airstream in a separate compartment. A cooling tube between the motor dome and discharge apron enables fresh air to be drawn into the motor housing during fan operation. This positive cooling promotes longer life for motor and drive components.

Easy Maintenance Access

By removing the fasteners, the motor dome lifts off for complete access to all the drive components.

Vibration Isolators

Multidirectional, rubber-in-shear vibration isolators mitigate residual vibration transmission from the unit to the building.

Structural Integrity

Durable housings of spun aluminum have a high strength-to-weight ratio and incorporate a rolled bead for additional strength. There are no welds to break or seams to leak. The heavy-gauge motor mounting platform provides positive rigidity between all components of the power train assembly.

Internal Bracing

Tri-Strut™ supports transfer the weight of the motor mounting platform directly to the curb mounting surface. The aluminum spun housing, therefore, is not used to support any weight. For grease laden applications, there is less surface for grease build-up during normal operation.

Solid Steel Shafts

Sized so the first critical speed is a minimum of 130% of maximum cataloged operating speed, shafts are precision ground, and polished.

Self-Aligning Bearings

Heavy-duty bearings are sized for a minimum L50 life in excess of 200,000 hours of operation. 100% factory tested, they are designed for air handling applications.

Drives and Belts

Pulleys are pre-set to the specified RPM. Cast iron variable pitch pulleys are adjustable, allowing for field balancing based on actual field conditions. All pulleys are sized for at least 150% of the driven horsepower.

Conduit

Both direct and belt drive units include a large 1" nominal conduit chase (not available on heat and smoke removal units; wiring is run via the cooling tubes) for easy installation of wiring from the motor dome to below the curb cap. Fatrap units are factory wired to an external NEMA 3R junction box.

Reverse Venturi

Reverse venturi reduces turbulence and improves distribution of the air as it enters the wheel inlet and is "captured" by the blades.

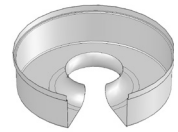

Wheels

Fumex fans offer patented wheel designs. Carefully matched, highly-tooled venturis enhance the performance of these backward inclined and non-overloading centrifugal wheels. Made of advanced aluminum alloys, the various wheel components provide superior strength and durability, as well as spark resistant construction. The heat and smoke removal configuration utilizes steel construction.

Silent Wheel (Direct Drive)

- Blades' highly curved leading edge provide unsurpassed low sound numbers with excellent air performance.
- Back plate and inlet are stamped for consistency, plus dynamic balancing assure smooth, vibration-free operation.
- Riveted or riveted and welded construction ensure superior dependability over other wheel designs.

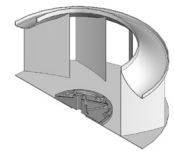

Standard Duty, All Welded Wheel

(Standard Duty & High Pressure Belt Drive)

- Blades are curved for improved air performance while increasing their strength and rigidity.
- Back plate and inlet are stamped for consistency. They include a perimeter rim which enhances strength and improves balancing.
- Wheel assembly is robotically welded to provide extremely durable and consistent performance.
- Wheel is dynamically balanced. Balancing weights are mechanically attached to the inside of the rims of both the back plate and wheel inlet. This allows a precise placement of the weights anywhere within a full 360° range on two separate planes, without the possibility of detachment.

OPTIONS & ACCESSORIES

Finishes

Coatings such as Polyester Powder Coat, Epoxy Powder Coat, Phenolic Epoxy Powder Coat, and others are available. See the coatings brochure for details.

Mounting Pedestal

The 12" high mounting pedestal, available in aluminum or galvanized steel, incorporates a removable access panel for easy inspection and service of motor operated back draft dampers. It provides solid ventilator support and a weather resistant seal that does not injure or disturb flashing. This item should not be used with Fatrap units.

Hinged Sub-Base

Hinged sub-bases provide access to the curb well for damper service or clean out for grease applications. Constructed with a rust proof hinge arrangement and low height (3 1/2") the assembly is easily manipulated and reduces the impact on overall installation height. This accessory is available for use with most all models for either factory built or existing roof curbs.

Floating Hinge Kit

A floating hinge kit is also available for field installation. This assembly connects the exhauster directly to the roof curb and provides the same level of access as the hinged sub-base.

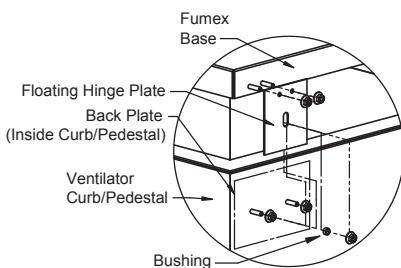

Aluminum Bird & Insect Screen

Bird screens are available for all direct and belt drive models. An aluminum insect screen with a smaller mesh than the standard bird screen is also available. However, please note that NFPA 96 installations do not allow the use of bird or insect screens. The requirements of local codes must be reviewed to determine if there are any conflicts.

Internal Wiring

NEMA 3R wiring is available for both direct and belt drive models.

Backdraft Dampers

Back draft dampers are available for either gravity or motorized operation (motor kit optional). Dampers feature square galvanized steel frame, multi-leaf, roll formed aluminum blades with nylon bearings. Back draft dampers should not be used when venting kitchen hoods. NFPA 96 installations do not allow the use of dampers. The requirements of local codes must be reviewed to determine if there are any conflicts.

Safety Disconnect Switch

Safety disconnect switches are available to allow positive electrical shut-off and safety. Switches are factory mounted when factory wiring is requested. Wiring is only run from the motor to the junction box. (Factory wiring of explosion proof applications is not available.) A wide range of NEMA rated enclosures with disconnect switches are available for indoor, outdoor, and explosion proof installations. Disconnects are to be field wired by a licensed electrician.



Firestat Switch

Firestat switch automatically disconnects the unit when the temperature of the air being exhausted exceeds a preset rating.



Time-Delay Switch

(Selected direct drive models only) The Airminder Model AM12 switch is a UL recognized and CSA certified time-delay relay that operates both the fan and room light to ventilate an area even after the occupants depart. In the "On" position, the Airminder turns the light and fan on immediately. In the "Off" position, the light goes off immediately and the fan is in operation for a period of time as preset from 1 to 60 minutes. Suitable only for 1/3 HP maximum at 120/1/60.



Speed Controllers

The Lek-Trol™ controller allows adjustment in speed to a maximum of 50% reduction, which results in a very cost effective means for system balancing. The device can be located under the fan dome to prevent unauthorized tampering or on the wall for ease of operation by the building occupants. (Available on direct drive units with ODP motors and some select TE motors. See reference table under Motor Availability)



Automatic Belt Tensioner

The factory mounted Automatic Belt Tensioner accessory eliminates the need for re-tensioning the belt after start-up. It is constructed from 10 gage galvanized steel and incorporates five torsion springs to automatically position the motor and maintain proper belt tension. Additional benefits include reduced belt and pulley wear and simplified belt replacement without tools. The Automatic Belt Tensioner is available for Fumex models FX08B, FX10B, FX12BH, FX13B, FX13BHFT and FX14B with 1/4, 1/2, 3/4, and 1 HP ODP motors. It can also be used with 1.5 HP, 3-phase ODP motors.

Spark Resistant Construction

AMCA 'B' construction is available as standard construction on direct drive units and as an option on belt drive units (not available on heat and smoke removal units). If required, an explosion proof motor and disconnect may be selected as options.

Wall Mounting

This option is provided as a separate product line, whose models include a "W" prefix. Product line includes models up to size 24, motors up to 2HP, and round bases (not available on heat and smoke removal units).

Prefabricated Curb

A variety of sizes of prefabricated roof curbs are available. Galvanized steel unibeam curbs are the most popular. For a complete listing of all curb types and sizes available, see the latest PennBarry Ventilation Curb brochure. Please note that NFPA 96 installations require a specific curb height. See Fatrap configuration on the next page.

OPTIONS & ACCESSORIES

Fumex Curb

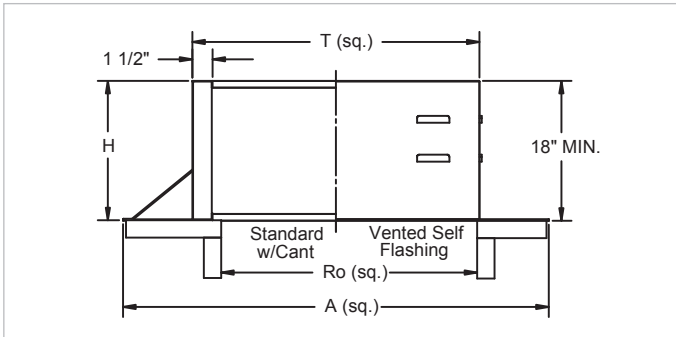

Model	E ⁽⁴⁾ SQ	T ⁽²⁾ SQ	A SQ	Ro ⁽³⁾ SQ	Damper Size SQ	Galv. Steel Gauge
FX08S/R	18.5	17	25	9	8.75	18
FX10S/R	18.5	17	25	11.5	11.25	18
FX11V/S/R/Q	18.5	17	25	11.5	11.25	18
FX13V/S/R/Q	18.5	17	25	11.5	11.25	18
FX16V/S/R/Q1/Q2	20.5	19	27	16	15.75	18
FX18V	28.5	27	35	20	19.75	18
FX08B to FX14B	24.75	23.25	31.25	16	15.75	18
FX12BH	24.75	23.25	31.25	16	15.75	18
FX13BHFT	24.75	23.25	31.25	16	15.75	18
FX16B and FX18B	28.5	27	35	20	19.75	18
FX18BH	28.5	27	35	20	19.75	18
FX24B	33.5	32	40	25	24.75	18
FX24BH	33.5	32	40	25	24.75	18
FX27B and FX30B	36.5	35	43	28	27.75	18
FX36B	44.5	43	51	36	35.5	18
FMX50B	59	57.5	65.5	50	49.5	18

Standard heights "H" are 8", 12", and 18" including wood nailer. "T" dimension of curb is 1 1/2" less than the dimension of inside base of fan ("E"). "Ro" refers to Roof Opening. "E" dimension is inside base of fan. For FT (Fatrap) units, curbs are cantless, 18" high and optionally vented.

Exploded View

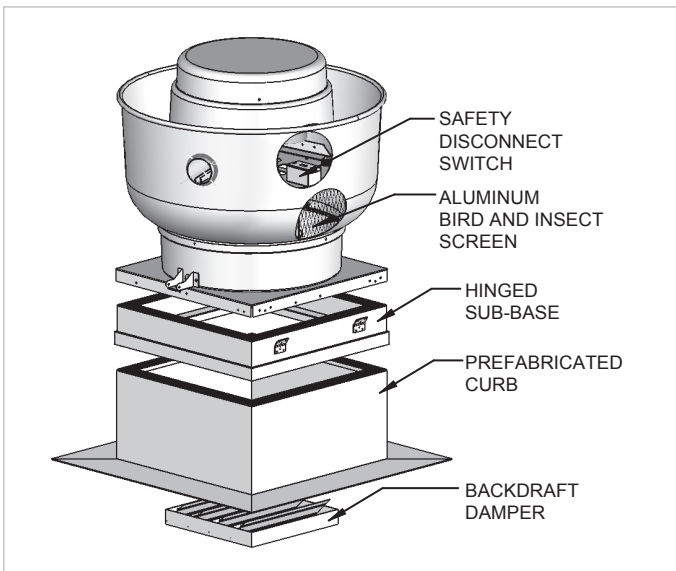

Fatrap Configuration

Fatrap configured fans are ideal for use in commercial kitchens over grilles, charcoal broilers, deep fat fryers, steam tables, ranges, dishwashers, and other appliances. Fumex fans are specially configured for food service applications with the addition of a group of accessories that either meets a requirement or eases installation requirements according to NFPA 96. NFPA 96 "Standard for Ventilation Control and Fire Protection of Commercial Cooking Operations" is the generally recognized authority nationwide for restaurant installation requirements. However, local codes may vary.

Included in the units are the following.

- **UL 762 Listing:** Fatrap configured Fumex fans are listed at 400°F — 100°F higher than UL requirements. The high temperature rating is the result of the fan's highly efficient forced motor cooling capability. Three direct drive (sizes 13 – 18) and all belt drive models are listed.
- **Pre-wired Junction Box:** A weather-proof junction box is factory wired and mounted to the housing exterior. An appropriately sized disconnect switch is commonly selected as an additional option. These items meet the code requirements for positive electric shut-off.
- **Grease Collector/Separator Box:** Designed for easy installation, the grease is routed from a single swiveling collection spout to an amply sized durable galvanized steel box, trapping grease and residue, and avoiding discharge onto the roof surface. Additionally, these boxes separate the water from the grease, prolonging the time required between periodic maintenance.

Additional Fatrap Accessories

Ventilated Curbs and Pedestals: For buildings two stories or higher NFPA 96 requires the use of ventilated mounting curbs or pedestals to provide an approved arrangement for connecting a range hood and duct work to the roof fan. PennBarry's ventilated mounting curbs and pedestals, 18" high, comply with that standard when properly installed. Ventilated curbs have a flat mounting flange for fastening directly to the roof deck. This flange should be securely fastened and flashed to ensure weather tightness. Ventilated pedestals are designed to fit on an existing curb. They provide cap flashing when so installed.

Make-Up Air Units (Suplex): Fumex fans with the Fatrap configuration can be combined with a PennBarry FS Muffan fan to create an integrated unit called the Suplex. The Fumex handles the required air flow to be exhausted while the Muffan provides an appropriate amount of supply make-up air. The modular design of the Suplex means that just one roof opening is needed for both the exhaust and supply ducts. An insulated shield divides the base to separate the exhaust and make-up air compartments, and prevents heat transfer between hot exhaust air and fresh filtered air. This results in a complete air-tight seal between the hood and exhaust fan.

©PENNBARRY 2014

OPTIONS & ACCESSORIES

Heat & Smoke Removal Configuration

While Fumex fans are commonly used for general ventilation, they are also designed to discharge contaminated or grease-laden air or fumes up and away from building surfaces with the Fatrap option and when equipped with the Heat and Smoke Removal option, this series of fans incorporates features exclusively designed to exhaust heat and smoke in the event of fire. During these emergencies, the fans are designed to operate at the temperature and time limits stated below. To maintain power to these fans during emergencies, special consideration must be made for field power supply. In the event of an emergency, if power is maintained, the units will operate for the times and temperatures indicated, after which they will continue to operate until they are destroyed by the extreme temperature generated during an actual fire, or their roof structure collapses.

For smoke control systems, Heat and Smoke Removal configured fans are listed per UL for emergency smoke removal, referencing UL705, UL793, Industrial Risk Insurers (IRI), and Southern Building Code Congress International (SBCCI).

The UL standard requires the fan to run at 500°F for 4 hours (IRI) and 1000°F for 15 minutes (SBCCI). PennBarry Heat and Smoke Removal configured Fumex units are listed at 500°F for 4 hours and 1000°F for 1 hour. The additional 45 minutes at 1000°F will buy precious time in the event of a fire.

Steel Wheel: The wheel is a standard duty, all welded wheel (standard duty and high pressure belt drive). The blades are curved for improved air performance while increasing their strength and rigidity. The wheel assembly is fully welded to provide extremely durable and consistent performance. The wheel is dynamically balanced. Balancing weights are mechanically attached to the inside of the rims of both the back plate and wheel inlet. This allows a precise placement of the weights anywhere within a full 360° range on two separate planes, without the possibility of detachment.

Forced Motor Cooling: Motors and drive components are located out of the airstream in a separate compartment. Two cooling tubes are located between the motor dome and discharge apron which enables fresh air to be drawn into the motor compartment during fan operation. This allows the cooler outside air to wash over the motor and bearings. This positive cooling promotes longer life for the motor and drive components.

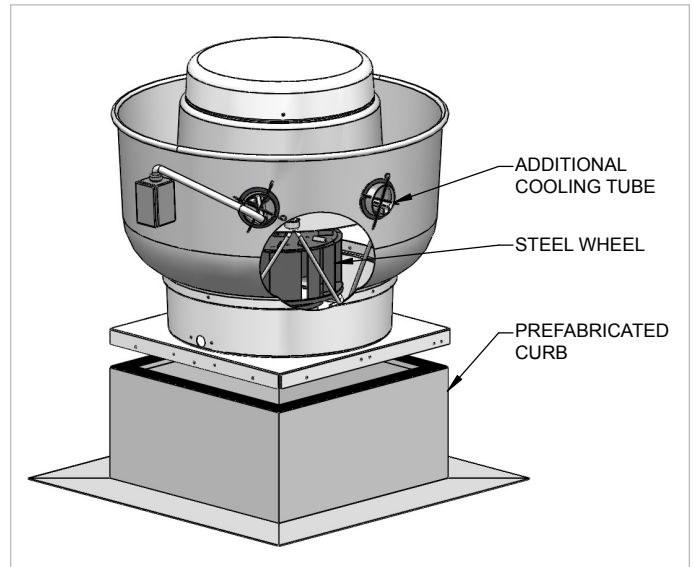

High Wind Construction

High wind construction Fumex fans are specifically designed for high wind hurricane zones (HWHZ). The Fumex models are designed to withstand 150 MPH winds in accordance with Miami-Dade and Florida Building Code standards. The units are 3rd party tested and certified through a 3rd party Professional Engineer (P.E.) to meet these strict standards. Installation details are provided and since there are no tie downs or external braces required for attaching the unit to the roof or curb this makes installation simple and easy. A wide range is offered to meet all of your ventilation needs which includes all belt and direct drive sizes 36 and under.

Product Certifications:

- Miami-Dade NOA # 14-0311.03
- Florida Product Approval #12339
- Texas Department of Insurance # RV-48

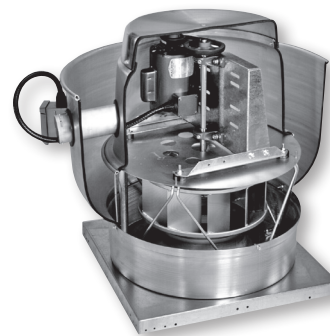

Belt Drive
Fumex Cutaway

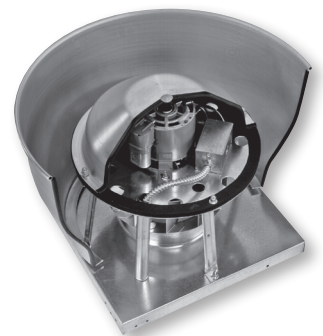

Direct Drive
Fumex Cutaway

MOTOR AVAILABILITY



Green Plus Electronically Commutated Motor

The Green Plus (GP) option utilizes EC motors to provide significantly greater efficiency, flexibility, and controllability over standard direct drive permanent split capacitor (PSC) motors. Using the included potentiometer, the Green Plus motors can be turned down to as low as 80% the max operating speed while maintaining 90% efficiency through the operating range. Additionally, the Green Plus can accept 0-10V input to tie to building management systems, allowing for savings in not only direct fan energy consumption but reducing the exhaust of conditioned air during off peak hours as well. All Green Plus motors come in open enclosure for usage with 115-208/230V, single phase, 60 Hz applications.

Model	Size	Tap	ECM HP
WFX/FX	08	S	0.33
	08	R	0.33
	10	S	0.33
	10	R	0.33
	11	V	0.33
	11	S	0.33
	11	R	0.33
	11	Q	0.33
	13	V	0.33
	13	S	0.33
	13	R	0.33
	13	Q	0.33
	16	V	0.33
	16	S	0.50
	16	R	0.50
	16	Q1	0.50
	16	Q2	0.75
	18	V	0.75

NEMA Motor

This chart summarizes the largest allowable NEMA frame sizes for motors used on belt drive models.

Largest Available NEMA Frame Size per Model

Model	Max. Frame Size	Model	Max. Frame Size
FX08B	56	FX18B	145T
FX10B	56	FX18BH	145T
FX12BH	56	FX24B	184T
FX13B	56	FX24BH	184T
FX13BHFT	56	FX27B/FX30B	184T
FX14B	56	FX36B	213T
FX16B	145T	FMX50B	215T

At PennBarry's option, large frame motors may be removed after testing and shipped separately. Contact the factory for special application motor availability.

Variable Speed Motor Control

PennBarry offers Lek-Trol™ solid state controllers to alter the high speed of most direct drive motors by as much as 50%. If variable speed is required, check the Lek-Trol™ availability table below to verify that controllers exist for the fan model selected. Remember, Lek-Trol™ controllers are currently only available for direct drive motors including all standard Open Drip Proof (ODP) 60 Hz motors. Not all totally enclosed motors are currently available with variable speed control. Inverter rated motors suitable for use with variable frequency drives can be supplied for belt drive models. Contact your local PennBarry representative for availability.

Available Lek-Trol™ Speed Controls

Model	60 Hz					50 Hz		
	ODP	Totally Enclosed				Totally Enclosed		
		115V	115V	200V	208V	230V	110V	220V
FX08S	-	-	-	-	-	-	-	-
FX08R	LT25	-	-	-	-	-	-	-
FX10S	-	-	-	-	-	-	-	-
FX10R	LT30	LT30	LT35	LT35	LT35	LT30	LT35	LT35
FX11V	-	-	-	-	-	-	-	-
FX11S	-	-	-	-	-	-	-	-
FX11R	LT30	-	-	-	-	-	-	-
FX11Q	LT50	-	-	-	-	-	-	-
FX13V	-	-	-	-	-	-	-	-
FX13S	-	-	-	-	-	-	-	-
FX13R	LT30	LT30	LT35	LT35	LT35	LT50	LT35	LT35
FX13Q	LT45	LT50	LT35	LT35	LT35	LT50	LT35	LT35
FX16V	-	-	-	-	-	-	-	-
FX16S	-	-	-	-	-	-	-	-
FX16R	LT50	-	-	-	-	-	-	-
FX16Q1	LT40	-	-	-	-	-	-	-
FX16Q2	LT75	-	-	-	-	-	-	-
FX18V	LT60	-	-	-	-	-	-	-

Lek-Trols™ indicated for multi-speed models (eg., FX16V/S/R) are applicable only for the high speed. Do not use on low or medium speed for multi-speed models. Items noted with (-) are not applicable.

©PENNBARRY 2014

MOTOR AVAILABILITY

Direct Drive Motor Availability

The following chart lists the various motor options available for each of the direct drive fan models. Once a fan model is selected, this chart can be used to determine if a suitable motor is available. (If not, another selection may have to be made from the fan performance charts). Look under the nominal RPM heading to determine which fans have 2-speed and 3-speed motors.

Model	Nominal RPM				1 Phase								
	1050 V	1300 S	1550 R	1725 Q	115 Volts			200 - 240 Volts					
					Open Drip Proof	Totally Enclosed	Explosion Proof	Open Drip Proof	Totally Enclosed	50 hz	50 C Ambient	Explosion Proof (4)	
FX08S/R	-	x	x	-	yes	yes (1)	-	Use TE Motors	yes (1)	yes (1)	yes (1)	-	
FX10S/R	-	x	x	-	yes	yes (1)	-		yes (1)	yes (1)	yes (1)	-	
FX11V/S/R	x	x	x	-	yes	yes (1)	-		yes (1)	yes (1)	yes (1)	-	
FX11Q	-	-	-	x	yes	yes	yes		yes	yes	yes	yes (5)	
FX13V/S/R	x	x	x	-	yes	yes (1)	-		yes (1)	yes (1)	yes (1)	-	
FX13Q	-	-	-	x	yes	yes	yes		yes	yes	yes	yes (5)	
FX16V/S/R	x	x	x	-	yes	yes (1)	-		yes (1)	yes (1)	yes (1)	-	
FX16Q1	-	-	-	x (3)	yes	-	-		-	-	-	-	
FX16Q2	-	-	-	x	yes	yes	yes		yes	yes	yes	yes (5)	
FX18V	x	-	-	-	yes	-	-		-	-	-	-	

Model	Nominal RPM				3 Phase				
	1050 V	1300 S	1550 R	1725 Q	200 - 460 Volts (2)				
					Open Drip Proof	Totally Enclosed	50 hz	50 C Ambient	Explosion Proof (4)
FX08S/R	-	x	x	-	Use TE Motors	-	-	-	-
FX10S/R	-	x	x	-		-	-	-	-
FX11V/S/R	x	x	x	-		-	-	-	-
FX11Q	-	-	-	x		-	-	-	yes (6)
FX13V/S/R	x	x	x	-		-	-	-	-
FX13Q	-	-	-	x		yes	yes	yes	yes (6)
FX16V/S/R	x	x	x	-		-	-	-	-
FX16Q1	-	-	-	x (3)		-	-	-	-
FX16Q2	-	-	-	x		-	-	-	yes (6)
FX18V	x	-	-	-		-	-	-	-

(1) High speed only.; (2) 200 - 240, 380, 415, 460 V; (3) Nominal 1650 RPM; (4) Cls.I, Grp.D, Div. I / Cls. II, Grp.F & G, Div.I., Not available with 50 Hz.; (5) 230 V only. Not available in 200 or 208 V; (6) 230 V and 460 V only.

FX08 - FX13 | DIRECT DRIVE

Performance Data Overview

Fumex direct drive models are available with single and multi-speed motors. Multi-speed motors (eg., FX16V/S/R) are designated: V (1050 RPM), S (1300 RPM), and R (1550 RPM). FX18V is an exception, being a single speed motor. Q, Q2 (1725 RPM) and Q1 (1650 RPM) are single speed motors. A single Fumex fan may be suitable for several requirements by a simple wiring change. This feature provides flexibility for a variety of

reasons, including energy savings, off hours requirements, future expansion, or unexpected field variations.

Fumex direct drive models are available in six sizes (8, 10, 11, 13, 16, and 18). Capacities up to 4500 CFM, with static pressures to 1 1/2".

By using Lek-Trol™ variable speed controllers, the high speed flow rate of most models can be reduced by as much

as 50%. Do not use Lek-Trol™ on medium or low speed for multi-speed models.

When compared to belt drive models, direct drive fans require less maintenance, have a simpler construction, cost less, and are lighter in weight.

Performances in 50 Hz applications will be less than shown below; consult your local PennBarry representative.

FX08 - FX11

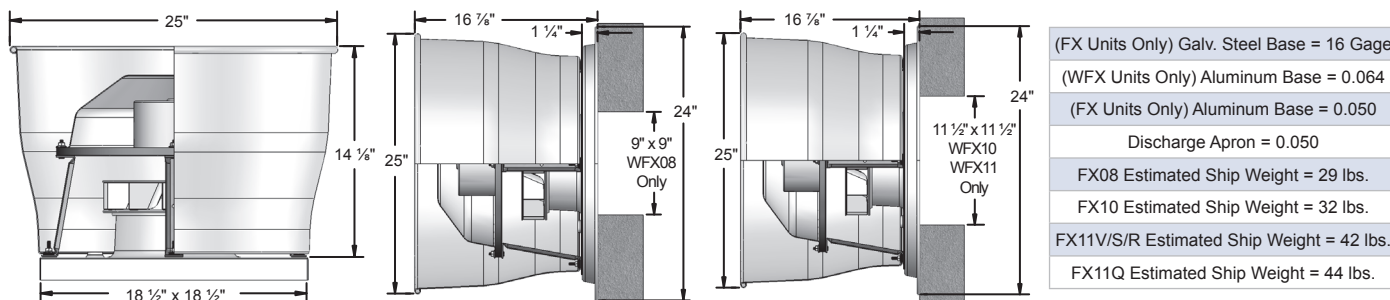

Model	Nominal			Tip Speed FPM	0.000" SP		0.125" SP		0.250" SP		0.375" SP		0.500" SP		0.625" SP		0.750" SP		1.000" SP	
	HP	Max Watts	RPM		CFM	Sones	CFM	Sones	CFM	Sones	CFM	Sones	CFM	Sones	CFM	Sones	CFM	Sones	CFM	Sones
FX08S	1/50	44	1300	3361	247	1.3	150	2.0	94	3.2	54	4.3	-	-	-	-	-	-	-	-
FX08R	1/30	55	1550	4007	288	2.4	205	2.9	154	3.5	112	4.4	72	5.2	-	-	-	-	-	-
FX10S	1/25	85	1300	3361	400	3.5	309	3.8	246	4.1	194	4.6	152	5.0	109	5.5	57	6.1	-	-
FX10R	1/12 ⁽¹⁾	122	1550	4007	570	6.2	500	6.6	440	6.8	385	6.8	325	6.8	251	6.9	170	7.1	-	-
FX11V	1/25	103	1050	3058	406	1.9	225	2.2	151	3.6	119	4.2	87	4.8	57	5.5	-	-	-	-
FX11S	1/11	142	1300	3786	534	3.9	414	4.2	337	5.1	273	5.9	223	6.2	177	6.5	129	6.9	-	-
FX11R	1/6 ⁽²⁾	199	1550	4514	760	7.6	667	7.4	586	7.6	512	7.9	434	8.9	359	9.6	283	9.6	118	9.7
FX11Q	1/5	255	1725	5024	1034	10.7	959	10.5	883	10.5	804	10.5	722	10.6	631	10.9	538	10.7	313	9.7

(1) TE motor is 1/6 Hp. (2) TE motor is 1/7 Hp. See additional notes on page 11.

FX13

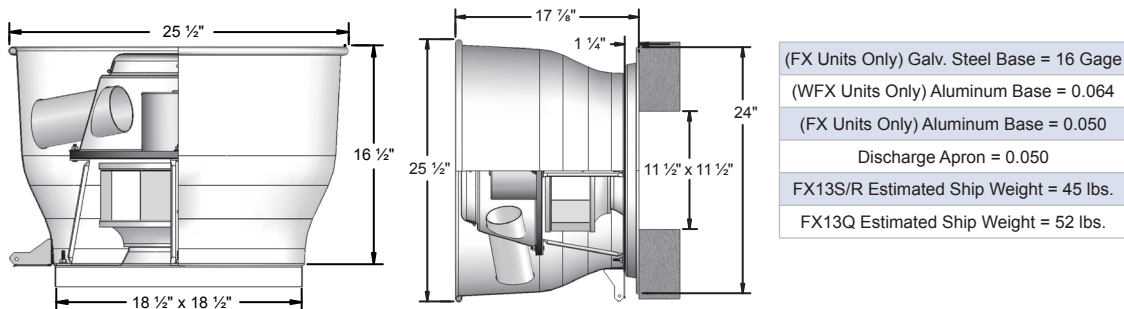

Model	Nominal			Tip Speed FPM	0.000" SP		0.125" SP		0.250" SP		0.375" SP		0.500" SP		0.625" SP		0.750" SP		1.000" SP		1.250" SP	
	HP	Max Watts	RPM		CFM	Sones	CFM	Sones	CFM	Sones	CFM	Sones	CFM	Sones	CFM	Sones	CFM	Sones	CFM	Sones	CFM	Sones
FX13V	1/20	113	1050	3221	640	4.2	469	2.8	317	2.4	250	3.1	197	3.8	149	4.5	106	5.2	-	-	-	-
FX13S	1/12	148	1300	3988	845	7.4	735	6.4	612	5.2	492	5.0	404	5.3	334	5.7	270	6.1	136	7.0	-	-
FX13R	1/6	188	1550	4755	1057	10.5	980	10.1	908	9.6	825	8.6	733	8.1	646	8.1	561	8.2	376	8.2	144	8.5
FX13Q	1/4	343	1725	5292	1261	13.6	1198	13.0	1143	12.6	1093	12.1	1033	11.7	973	11.2	909	10.8	757	10.1	515	9.6

See notes on page 11.

FX16 - FX18 | DIRECT DRIVE

FX16

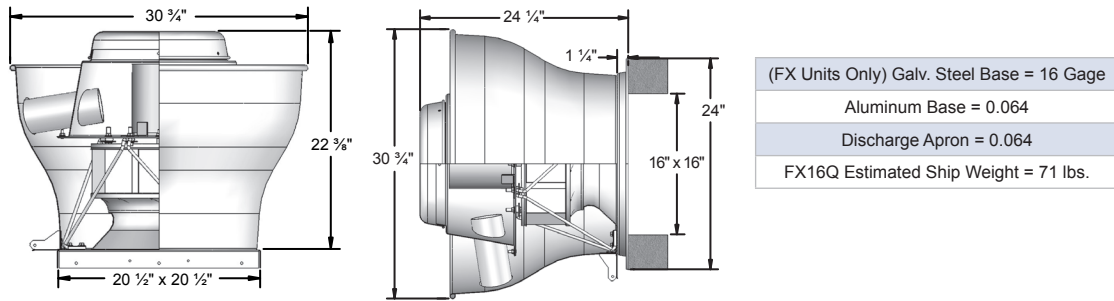

Model	Nominal			Tip Speed FPM	0.000" SP		0.125" SP		0.250" SP		0.375" SP		0.500" SP		0.625" SP		0.750" SP		1.000" SP		1.250" SP		1.500" SP	
	HP	Max Watts	RPM		CFM	Sones	CFM	Sones	CFM	Sones	CFM	Sones	CFM	Sones	CFM	Sones	CFM	Sones	CFM	Sones	CFM	Sones	CFM	Sones
FX16V	1/6	485	1050	3788	1604	7.9	1358	6.5	1128	5.5	951	5.8	801	6.3	705	6.9	644	7.7	522	9.2	384	9.3	230	9.7
FX16S	1/3	527	1300	4690	1874	10.7	1693	9.5	1514	8.6	1326	8.0	1158	7.6	1023	7.7	913	8.2	735	9.6	572	9.7	379	9.9
FX16R	1/3 ⁽¹⁾	590	1550	5592	2140	12.8	1994	11.9	1849	11.0	1709	10.2	1561	9.9	1410	9.6	1269	9.4	1033	9.7	812	11.1	583	10.8
FX16Q1	1/2	715	1650	5953	2531	15.2	2432	14.7	2332	14.2	2232	13.7	2114	13.1	1992	12.5	1868	11.9	1582	11.0	1320	11.5	1001	12.1
FX16Q2	3/4	890	1725	6223	2822	17.1	2753	16.8	2684	16.5	2594	16.1	2501	15.7	2418	15.4	2331	15.1	2119	14.2	1872	14.1	1566	14.2

(1) TE motor is 1/2 Hp. See additional notes at bottom of page.

FX18

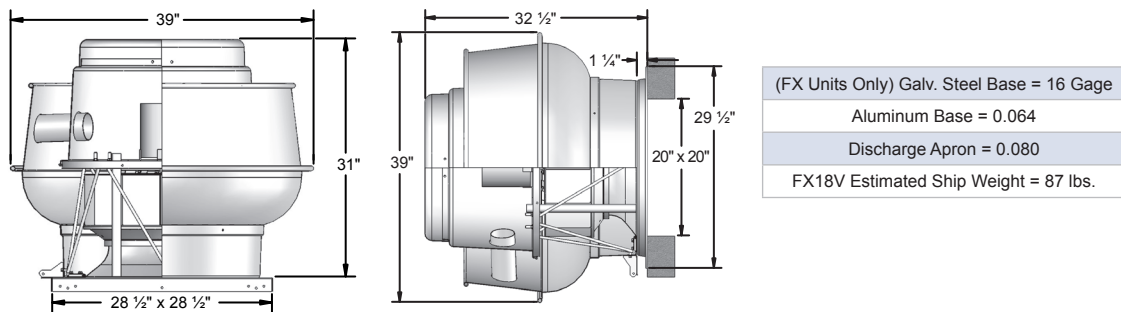

Model	Nominal			Tip Speed FPM	0.000" SP		0.125" SP		0.250" SP		0.375" SP		0.500" SP		0.625" SP		0.750" SP		1.000" SP		1.250" SP		1.500" SP	
	HP	Max Watts	RPM		CFM	Sones	CFM	Sones	CFM	Sones	CFM	Sones	CFM	Sones	CFM	Sones	CFM	Sones	CFM	Sones	CFM	Sones	CFM	Sones
FX18V	3/4	969	1075	6029	4489	21.0	4333	21.0	4177	20.0	4011	19.1	3831	18.1	3652	17.6	3455	17.2	3023	16.5	2431	17.5	1447	20.0

Performance shown is for installation Type A: Free Inlet, Free Outlet. Speed (RPM) shown is nominal. Performance is based on actual speed of test. The sound ratings shown are for loudness values in fan sones at 5'0" (1.5m) in a hemispherical free field per AMCA Standard 301. Values shown are for Installation Type A: free inlet hemispherical sone levels. Performance ratings do not include the effects of appurtenances in the air stream.

Fumex fans are only one component of a total system. As such, fan performance is directly affected by the system. It is critical that system designers determine the actual system loss to ensure that the actual flow is specified in the system design.

DIRECT DRIVE PERFORMANCE DATA

Fan Curves

The fan curves illustrated here show the range of capacities available for direct drive units. Each graph shows the performance of several models at one particular nominal speed. Fan curves provide a quick method for selecting a fan unit based on design point requirements.

The direct drive performance charts on the previous pages provides the tabular data (CFM and static pressure) used to plot the fan curves. In addition, the horsepower tip speed and sones are tabulated. Since sound is normally an important factor in the selection of a fan, an engineer will usually want to select the "slowest" unit which meets CFM and SP requirements.

Please refer to the Motor Availability section to make sure the motor you select meets your electrical requirements.

Nominal 1075 RPM

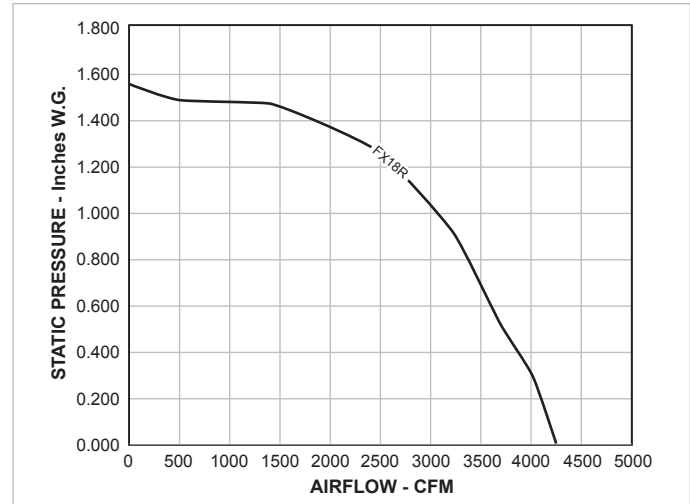

Nominal 1050 RPM

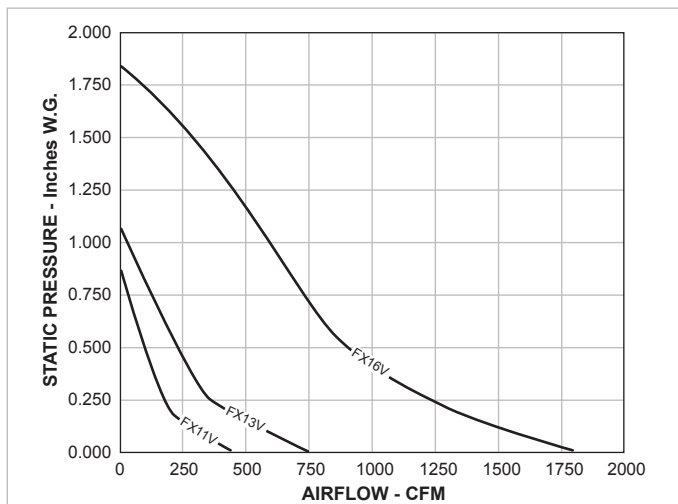

Nominal 1550 RPM

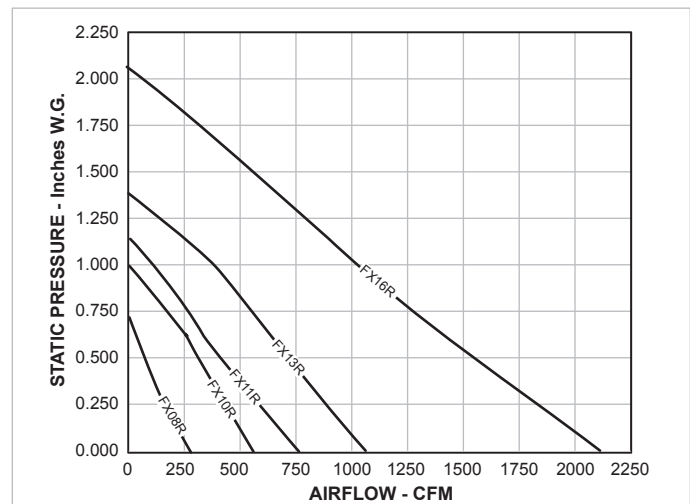

Nominal 1300 RPM

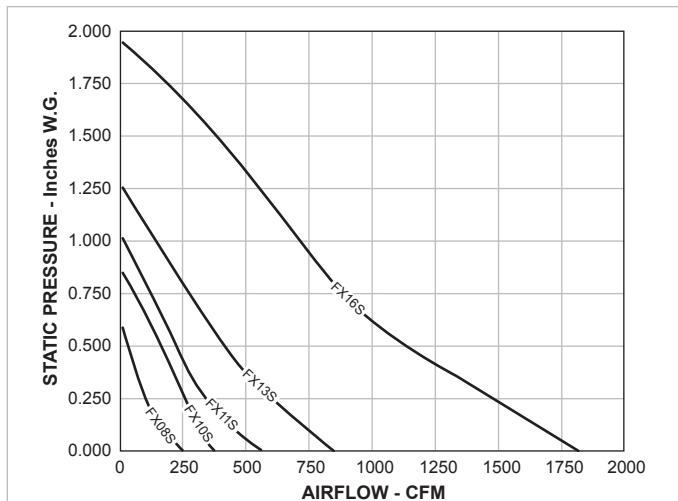

Nominal 1725 RPM

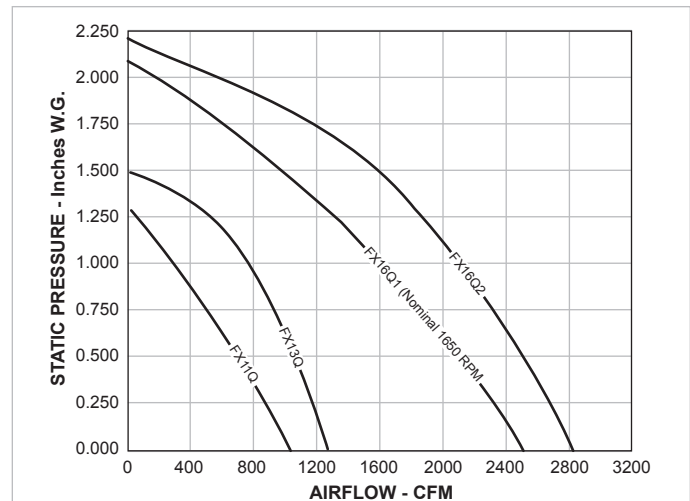

Fumex fans are only one component of a total system. As such, fan performance is directly affected by the system. It is critical that system designers determine the actual system loss to ensure that the actual flow is specified in the system design. Performance shown is for installation Type A: Free Inlet, Free Outlet. Speed (RPM) shown is nominal. Performance is based on actual speed of test. Performance ratings do not include the effects of appurtenances in the air stream.

©PENNBARRY 2014

BELT DRIVE PERFORMANCE DATA

Performance Data

The belt drive models shown on the following pages have sizes and capacities ranging from below 250 CFM to above 30,000 CFM, with static pressures from 0" to 4". All models are available with a wide range of horsepower sizes and RPM's. Two-speed motors are commonly used to enhance this flexibility.

The data provided for each belt drive model includes:

- Elevation Drawing Showing Overall Dimensions
- Fan Curve Graph
- Performance Chart

Each curve graphically displays the range of capacities available for each model, in most cases beyond the specifics shown in the tabular data. The maximum performance afforded by each horsepower is indicated by dashed lines and the RPM is indicated by solid lines.

Some models have graphs that show both shaded and unshaded areas. Selection should be made from the unshaded area only. Shaded areas reflect unstable performance ("surge"), a characteristic typical of backward inclined wheels, and should be avoided. These unstable regions are not shown in the tabular data.

The highest RPM shown for a specific horsepower in the tabular data is the maximum speed that for any point along the performance curve, the BHP will not exceed the available horsepower.

It is important to note that while it is common industry-wide practice to exceed a "nominal" horsepower by using a motor's service factor, PennBarry uses a conservative portion of the service factor, allowing half to remain a true "safety" factor.

Use the Motor Availability chart (see Motor Selection) to select motor enclosures and voltages which can be installed in the fans.

Note: Fumex fans are only one component of a total system. As such, performance is directly affected by the system. It is critical that system designers determine actual system losses to ensure that the actual flow is specified in the system range.

Belt Drive Losses

The AMCA Review Committee has developed the chart shown below for the purpose of estimating belt drive losses. To calculate total BHP (including drive losses): Find the BHP of your operating point on the x-axis on the graph below. Follow the vertical line to the curves indicating the range of drive losses. Look at the y-axis on the left and find the drive loss percentage. Calculate the total BHP by adding the drive loss to the operating point BHP. For BHP's below 0.3, use 30%.

Drive Loss Reference Chart

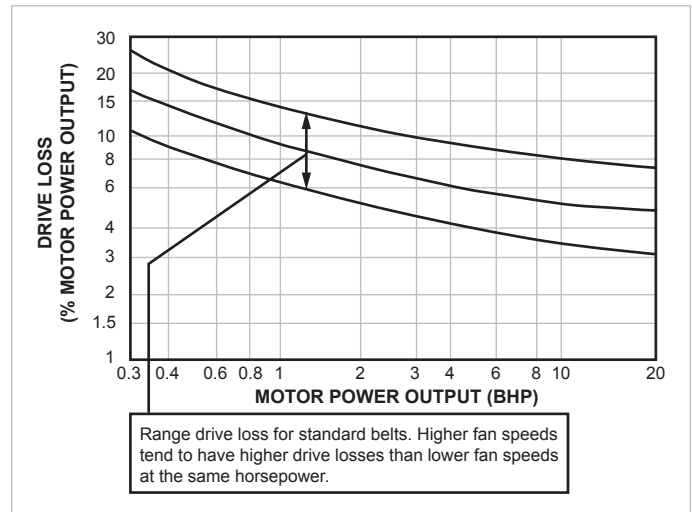

For totally enclosed, explosion proof, multi-speed and all 1.0 Service Factor motors, fan BHP plus drive losses should not exceed motor rated HP.

Graph reprinted from AMCA publication 203, with the express written permission from the Air Movement and Control Association, Inc., 30 West University Drive, Arlington Heights, IL 60004-1983.

FX08B | BELT DRIVE

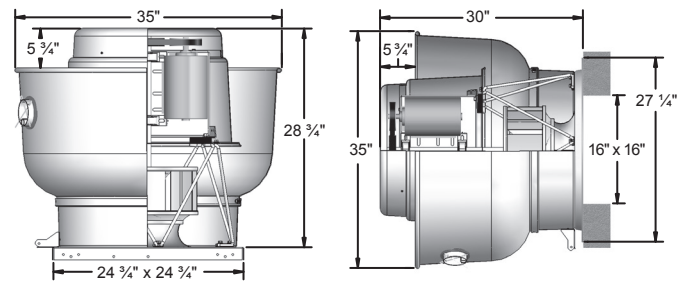
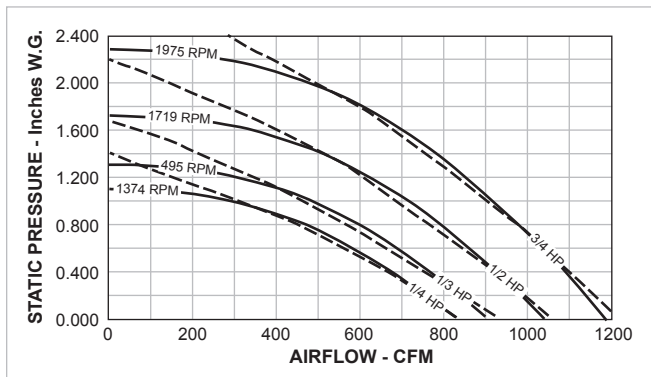

Galv. Steel Base = 16 Gage	Roof/Wall Opening = 16" SQ.	Peak BHP = (RPM/2126) ³
Aluminum Base = 0.064	Damper Size = 15 3/4" SQ.	Max. RPM = 2085 (1 HP)
Discharge Apron = 0.064	Max. Motor Frame Size = 55	Est. Ship Weight = 96 lbs.*

* Add 8 lbs. for Heat & Smoke option.

HP	RPM	Tip Speed FPM	0.000" SP		0.125" SP		0.250" SP		0.375" SP		0.500" SP		0.625" SP		0.750" SP		0.875" SP		1.000" SP		1.125" SP		
			Sones	BHP	Sones	BHP	Sones	BHP	Sones	BHP	Sones	BHP	Sones	BHP	Sones	BHP	Sones	BHP	Sones	BHP	Sones	BHP	Sones
1/4	350	1191	208	-	-	-	-	-	-	-	-	-	-	-	-	-	-	-	-	-	-	-	-
			1.7	0.01	-	-	-	-	-	-	-	-	-	-	-	-	-	-	-	-	-	-	-
	525	1787	312	-	-	-	-	-	-	-	-	-	-	-	-	-	-	-	-	-	-	-	-
			4.2	0.01	4.2	0.01	-	-	-	-	-	-	-	-	-	-	-	-	-	-	-	-	-
	700	2382	416	-	320	-	163	-	-	-	-	-	-	-	-	-	-	-	-	-	-	-	-
			4.5	0.03	4.4	0.03	4.2	0.03	-	-	-	-	-	-	-	-	-	-	-	-	-	-	-
	875	2978	520	-	447	-	359	-	231	-	-	-	-	-	-	-	-	-	-	-	-	-	-
			5.9	0.06	5.8	0.07	5.6	0.07	5.3	0.07	-	-	-	-	-	-	-	-	-	-	-	-	-
1050	3574	624	-	563	-	497	-	422	-	324	-	108	-	-	-	-	-	-	-	-	-	-	
		8.0	0.11	7.9	0.11	7.6	0.12	7.3	0.12	6.9	0.12	6.0	0.10	-	-	-	-	-	-	-	-	-	-
1225	4169	728	-	677	-	623	-	564	-	498	-	421	-	306	-	-	-	-	-	-	-	-	
		10.6	0.17	10.4	0.18	10.2	0.18	9.8	0.18	9.4	0.19	9.0	0.19	8.3	0.18	-	-	-	-	-	-	-	-
1374	4676	817	-	771	-	724	-	674	-	619	-	560	-	493	-	407	-	275	-	-	-	-	
		12.1	0.25	11.9	0.25	11.6	0.25	11.3	0.26	11.0	0.26	10.7	0.27	10.3	0.26	9.9	0.26	9.2	0.24	-	-	-	-
1/3	1410	4799	838	-	793	-	748	-	700	-	647	-	591	-	528	-	455	-	346	-	152	-	
			12.6	0.27	12.3	0.27	12.1	0.27	11.8	0.27	11.4	0.28	11.1	0.29	10.8	0.29	10.4	0.28	9.9	0.27	9.0	0.23	
	1440	4901	856	-	812	-	767	-	722	-	670	-	616	-	557	-	489	-	394	-	252	-	
			13.0	0.28	12.7	0.29	12.5	0.29	12.2	0.29	11.8	0.30	11.5	0.30	11.2	0.31	10.9	0.30	10.4	0.29	9.7	0.27	
1470	5003	874	-	831	-	787	-	743	-	693	-	640	-	584	-	519	-	437	-	318	-		
		13.4	0.30	13.2	0.31	12.9	0.31	12.6	0.31	12.3	0.32	11.9	0.32	11.6	0.33	11.3	0.32	11.0	0.31	10.3	0.30		
1495	5088	889	-	846	-	804	-	760	-	711	-	660	-	605	-	543	-	472	-	366	-		
		13.8	0.32	13.5	0.32	13.3	0.33	13.0	0.33	12.7	0.33	12.3	0.34	11.9	0.34	11.6	0.34	11.4	0.33	10.9	0.32		
1/2	1535	5224	912	-	871	-	830	-	787	-	741	-	692	-	639	-	582	-	518	-	429	-	
			14.3	0.34	14.0	0.35	13.8	0.35	13.5	0.35	13.2	0.36	12.9	0.37	12.5	0.37	12.1	0.37	11.8	0.37	11.5	0.35	
	1565	5326	930	-	890	-	849	-	807	-	763	-	715	-	664	-	611	-	548	-	472	-	
			14.6	0.36	14.4	0.37	14.1	0.37	13.8	0.37	13.5	0.38	13.2	0.39	12.8	0.39	12.5	0.39	12.1	0.39	11.9	0.38	
	1595	5428	948	-	909	-	869	-	828	-	785	-	738	-	689	-	637	-	578	-	511	-	
			14.9	0.39	14.0	0.39	14.5	0.40	14.2	0.40	13.9	0.40	13.5	0.41	13.2	0.41	12.9	0.42	12.5	0.41	12.3	0.41	
	1630	5548	969	-	930	-	891	-	851	-	810	-	764	-	717	-	667	-	612	-	551	-	
			15.4	0.41	15.1	0.42	14.9	0.42	14.6	0.42	14.3	0.42	14.0	0.43	13.6	0.44	13.3	0.44	13.0	0.44	12.7	0.44	
	1665	5667	990	-	952	-	914	-	875	-	835	-	790	-	745	-	696	-	646	-	587	-	
			15.8	0.44	16.7	0.44	15.3	0.45	15.1	0.45	14.8	0.45	14.5	0.46	14.1	0.47	13.8	0.47	13.5	0.48	13.1	0.47	
	1695	5769	1008	-	970	-	933	-	895	-	856	-	813	-	768	-	721	-	672	-	616	-	
			16.2	0.46	17.1	0.47	15.7	0.47	15.5	0.48	15.2	0.48	14.9	0.48	14.6	0.49	14.2	0.50	13.9	0.50	13.6	0.50	
1719	5850	1022	-	985	-	948	-	911	-	872	-	830	-	787	-	741	-	693	-	640	-		
		16.6	0.48	16.4	0.49	16.1	0.49	15.9	0.50	15.6	0.50	15.2	0.50	14.9	0.51	14.6	0.52	14.3	0.52	13.9	0.52		
3/4	1755	5973	1043	-	1007	-	971	-	934	-	897	-	857	-	814	-	770	-	723	-	674	-	
			17.1	0.51	16.9	0.52	16.7	0.52	16.4	0.53	16.2	0.53	15.8	0.53	15.5	0.54	15.2	0.55	14.8	0.55	14.5	0.56	
	1795	6109	1067	-	1032	-	997	-	961	-	924	-	886	-	844	-	802	-	757	-	711	-	
			17.7	0.55	17.5	0.56	17.3	0.56	17.0	0.56	16.8	0.56	16.5	0.57	16.2	0.58	15.8	0.58	15.5	0.59	15.2	0.59	
	1830	6228	1088	-	1053	-	1019	-	984	-	948	-	911	-	870	-	829	-	786	-	741	-	
			18.3	0.58	18.1	0.59	17.8	0.59	17.6	0.60	17.4	0.60	17.1	0.60	16.8	0.61	16.5	0.62	16.2	0.62	15.9	0.63	
	1860	6330	1106	-	1072	-	1038	-	1003	-	968	-	933	-	893	-	853	-	810	-	766	-	
			18.8	0.61	18.6	0.62	18.4	0.62	18.1	0.63	17.9	0.63	17.6	0.63	17.3	0.64	17.0	0.65	16.7	0.66	16.4	0.66	
	1890	6432	1124	-	1090	-	1057	-	1023	-	988	-	953	-	915	-	875	-	834	-	791	-	
			19.4	0.64	19.1	0.65	18.9	0.65	18.6	0.66	18.4	0.66	18.1	0.66	17.8	0.67	17.5	0.68	17.2	0.68	17.0	0.69	
	1920	6535	1141	-	1109	-	1076	-	1042	-	1008	-	974	-	937	-	898	-	858	-	816	-	
			19.8	0.67	19.6	0.68	19.4	0.68	19.1	0.69	18.9	0.69	18.6	0.69	18.3	0.70	18.0	0.71	17.7	0.72	17.4	0.72	
	1950	6637	1159	-	1127	-	1095	-	1062	-	1028	-	995	-	959	-	920	-	882	-	841	-	
			20.0	0.70	20.0	0.71	19.8	0.72	19.6	0.72	19.3	0.72	19.1	0.72	18.8	0.73	18.5	0.74	18.2	0.75	17.9	0.75	
	1975	6722	1174	-	1142	-	1110	-	1078	-	1045	-	1012	-	977	-	939	-	901	-	861	-	
			21.0	0.73	20.0	0.74	20.0	0.74	20.0	0.75	19.7	0.75	19.5	0.75	19.1	0.76	18.8	0.77	18.6	0.78	18.3	0.78	

Performance shown is for installation type A: Free Inlet, Free Outlet. Power rating (BHP) does not include drive losses. For further information on estimating belt drive losses and motor service factors see page 12. The sound ratings shown are for loudness values in fan sones at 5'0" (1.5m) in a hemispherical free field per AMCA Standard 301. Values shown are for installation Type A: free inlet hemispherical sone levels. Performance ratings do not include the effects of appurtenances in the airstream.

©PENNBARRY 2014

FX10B | BELT DRIVE

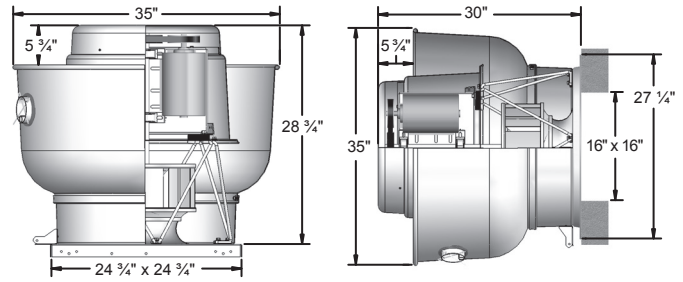
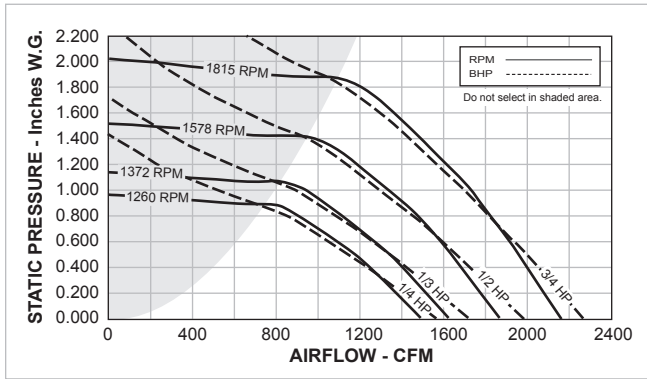

Galv. Steel Base = 16 Gage	Roof/Wall Opening = 16" SQ.	Peak BHP = (RPM/1869) ³
Aluminum Base = 0.064	Damper Size = 15 3/4" SQ.	Max. RPM = 2085 (1 1/2 HP)
Discharge Apron = 0.064	Max. Motor Frame Size = 56	Est. Ship Weight = 96 lbs.*

* Add 8 lbs. for Heat & Smoke option.

HP	RPM	Tip Speed FPM	0.000" SP		0.125" SP		0.250" SP		0.375" SP		0.500" SP		0.625" SP		0.750" SP		1.000" SP		1.125" SP		1.250" SP			
			Sones	BHP	Sones	BHP	Sones	BHP	Sones	BHP	Sones	BHP	Sones	BHP	Sones	BHP	Sones	BHP	Sones	BHP	Sones	BHP	Sones	BHP
1/4	600	2042	714	543	-	-	-	-	-	-	-	-	-	-	-	-	-	-	-	-	-	-	-	
	750	2553	892	765	596	-	-	-	-	-	-	-	-	-	-	-	-	-	-	-	-	-	-	
			6.7	0.05	6.6	0.05	6.5	0.06	-	-	-	-	-	-	-	-	-	-	-	-	-	-	-	
	900	3063	1071	968	854	696	-	-	-	-	-	-	-	-	-	-	-	-	-	-	-	-	-	
	1000	3403	1190	1097	998	874	730	-	-	-	-	-	-	-	-	-	-	-	-	-	-	-	-	-
			8.6	0.11	8.4	0.12	8.3	0.13	8.3	0.13	8.4	0.13	-	-	-	-	-	-	-	-	-	-	-	-
	1100	3744	1309	1225	1136	1042	915	780	-	-	-	-	-	-	-	-	-	-	-	-	-	-	-	-
10.4			0.14	10.2	0.15	10.0	0.16	9.9	0.17	9.9	0.18	9.9	0.18	-	-	-	-	-	-	-	-	-	-	-
1260	4288	1499	1426	1352	1271	1187	1076	961	-	-	-	-	-	-	-	-	-	-	-	-	-	-	-	
		13.5	0.22	13.2	0.23	13.0	0.24	12.7	0.25	12.6	0.26	12.6	0.26	12.6	0.26	-	-	-	-	-	-	-	-	-
1/3	1300	4424	1547	1476	1404	1327	1249	1144	1035	-	-	-	-	-	-	-	-	-	-	-	-	-	-	
	1325	4509	13.9	0.24	13.6	0.25	13.4	0.26	13.1	0.27	13.0	0.28	12.9	0.29	12.9	0.29	-	-	-	-	-	-	-	-
			15.77	1507	1437	1361	1285	1187	1080	-	-	-	-	-	-	-	-	-	-	-	-	-	-	-
	1350	4595	14.2	0.25	13.9	0.26	13.7	0.28	13.4	0.29	13.2	0.30	13.1	0.31	13.1	0.31	-	-	-	-	-	-	-	-
			16.07	1538	1469	1396	1320	1229	1125	892	-	-	-	-	-	-	-	-	-	-	-	-	-	-
1372	4669	14.4	0.27	14.2	0.28	13.9	0.29	13.7	0.30	13.4	0.31	13.4	0.32	13.3	0.32	13.3	0.32	13.3	0.32	-	-	-	-	
		16.33	1565	1497	1426	1352	1266	1164	943	-	-	-	-	-	-	-	-	-	-	-	-	-	-	-
1/2	1390	4731	1654	1587	1521	1450	1377	1296	1195	984	-	-	-	-	-	-	-	-	-	-	-	-	-	
	1420	4833	15.0	0.29	14.7	0.30	14.5	0.32	14.2	0.33	13.9	0.34	13.8	0.35	13.6	0.35	13.6	0.35	-	-	-	-	-	
			16.90	1624	1559	1491	1419	1345	1247	1044	909	-	-	-	-	-	-	-	-	-	-	-	-	-
	1450	4935	15.4	0.31	15.2	0.32	14.9	0.34	14.6	0.35	14.3	0.36	14.1	0.37	13.9	0.37	13.9	0.38	13.9	0.38	13.9	0.38	-	-
			17.26	1662	1597	1531	1461	1391	1298	1100	988	-	-	-	-	-	-	-	-	-	-	-	-	-
	1475	5020	15.9	0.33	15.7	0.34	15.4	0.36	15.1	0.37	14.8	0.38	14.6	0.39	14.4	0.40	14.3	0.40	14.3	0.40	14.3	0.40	-	-
			17.55	1692	1629	1565	1496	1427	1340	1147	1045	-	-	-	-	-	-	-	-	-	-	-	-	-
	1500	5105	16.3	0.35	16.1	0.36	15.9	0.38	15.6	0.39	15.3	0.40	15.0	0.41	14.8	0.42	14.6	0.42	14.6	0.42	14.6	0.42	-	-
			17.85	1723	1661	1599	1531	1463	1382	1193	1096	968	-	-	-	-	-	-	-	-	-	-	-	-
	1525	5190	16.7	0.36	16.5	0.38	16.3	0.39	16.0	0.41	15.7	0.42	15.4	0.43	15.1	0.44	14.9	0.44	14.9	0.44	14.9	0.44	14.9	0.44
18.15			1754	1693	1632	1565	1498	1423	1239	1143	1034	-	-	-	-	-	-	-	-	-	-	-	-	
1550	5275	17.0	0.38	16.8	0.40	16.6	0.41	16.3	0.43	15.9	0.44	15.6	0.45	15.3	0.46	15.0	0.47	15.0	0.47	15.0	0.47	15.0	0.47	
		18.45	1785	1725	1665	1600	1534	1465	1284	1190	1091	-	-	-	-	-	-	-	-	-	-	-	-	
1578	5371	17.2	0.40	17.0	0.42	16.8	0.43	16.5	0.45	16.2	0.46	15.8	0.47	15.6	0.48	15.1	0.49	15.1	0.49	15.1	0.49	15.1	0.49	
		18.78	1819	1760	1701	1638	1573	1509	1333	1241	1149	-	-	-	-	-	-	-	-	-	-	-	-	
3/4	1600	5445	17.4	0.42	17.2	0.44	17.0	0.46	16.8	0.47	16.4	0.48	16.1	0.49	15.8	0.51	15.3	0.52	15.3	0.52	15.3	0.52	15.3	0.52
	1630	5548	19.04	1846	1788	1730	1668	1604	1541	1371	1282	1191	-	-	-	-	-	-	-	-	-	-	-	
			17.6	0.44	17.4	0.46	17.2	0.47	16.9	0.49	16.6	0.50	16.3	0.51	16.0	0.53	15.4	0.54	15.4	0.54	15.4	0.54	15.4	0.54
	1660	5650	19.40	1883	1826	1769	1709	1646	1584	1423	1336	1247	-	-	-	-	-	-	-	-	-	-	-	
			17.8	0.47	17.6	0.48	17.4	0.50	17.2	0.52	16.9	0.53	16.6	0.54	16.2	0.55	15.5	0.57	15.5	0.57	15.5	0.57	15.5	0.57
	1695	5769	19.76	1920	1864	1808	1749	1688	1627	1474	1390	1302	-	-	-	-	-	-	-	-	-	-	-	
			18.0	0.49	17.9	0.51	17.7	0.53	17.5	0.54	17.2	0.56	16.9	0.57	16.5	0.58	15.8	0.60	15.7	0.60	15.7	0.60	15.7	0.60
	1730	5888	20.17	1962	1908	1853	1796	1736	1676	1534	1451	1367	-	-	-	-	-	-	-	-	-	-	-	
			18.4	0.53	18.2	0.54	18.1	0.56	17.9	0.58	17.6	0.59	17.3	0.60	16.9	0.62	16.2	0.63	16.0	0.64	16.0	0.64	16.0	0.64
	1765	6007	20.59	2005	1952	1898	1843	1784	1726	1592	1511	1430	-	-	-	-	-	-	-	-	-	-	-	
			18.8	0.56	18.6	0.58	18.5	0.59	18.3	0.61	18.0	0.63	17.7	0.64	17.4	0.65	16.7	0.67	16.3	0.68	16.3	0.68	16.3	0.68
	1790	6092	21.01	2048	1995	1943	1890	1832	1775	1650	1571	1492	-	-	-	-	-	-	-	-	-	-	-	
			19.3	0.59	19.2	0.61	19.0	0.63	18.9	0.65	18.6	0.66	18.3	0.68	18.0	0.69	17.3	0.71	16.8	0.72	16.7	0.72	16.7	0.72
1815	6177	21.30	2078	2027	1975	1923	1866	1810	1692	1613	1535	-	-	-	-	-	-	-	-	-	-	-		
		19.8	0.62	19.6	0.64	19.5	0.66	19.4	0.67	19.0	0.69	18.7	0.70	18.4	0.72	17.7	0.74	17.3	0.75	17.0	0.75	17.0	0.75	
		21.60	2109	2058	2007	1955	1900	1844	1732	1655	1578	-	-	-	-	-	-	-	-	-	-	-		
		20.0	0.65	20.0	0.66	20.0	0.68	19.9	0.70	19.6	0.72	19.2	0.73	18.9	0.75	18.2	0.77	17.8	0.78	17.3	0.78	17.3	0.78	

Performance shown is for installation type A: Free Inlet, Free Outlet. Power rating (BHP) does not include drive losses. For further information on estimating belt drive losses and motor service factors see page 12. The sound ratings shown are for loudness values in fan sones at 5'0" (1.5m) in a hemispherical free field per AMCA Standard 301. Values shown are for installation Type A: free inlet hemispherical sone levels. Performance ratings do not include the effects of appurtenances in the airstream.

FX12BH | BELT DRIVE

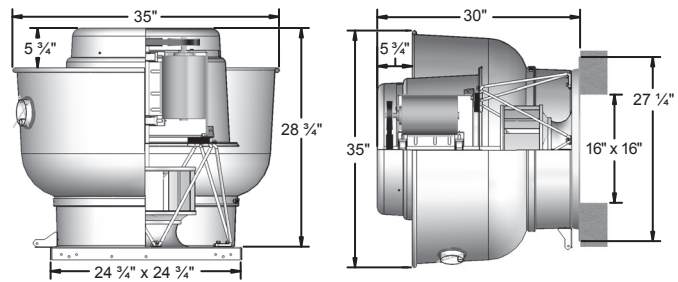
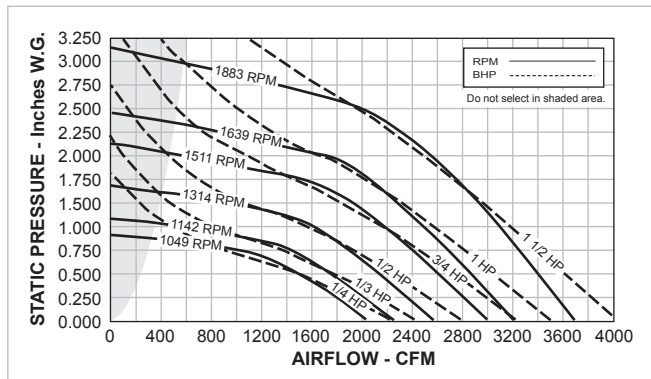

Galv. Steel Base = 16 Gage	Roof/Wall Opening = 16" SQ.	Peak BHP = (RPM/1632) ³
Aluminum Base = 0.064	Damper Size = 15 3/4" SQ.	Max. RPM = 2440 (1 HP)
Discharge Apron = 0.064	Max. Motor Frame Size = 56	Est. Ship Weight = 109 lbs.*

* Add 8 lbs. for Heat & Smoke option.

HP	RPM	Tip Speed FPM	0.250" SP		0.500" SP		0.750" SP		1.000" SP		1.250" SP		1.500" SP		1.750" SP		2.000" SP		2.250" SP		2.500" SP			
			Sones	BHP	Sones	BHP	Sones	BHP	Sones	BHP	Sones	BHP	Sones	BHP	Sones	BHP	Sones	BHP	Sones	BHP	Sones	BHP	Sones	BHP
1/4	840	3491	1320	794	-	-	-	-	-	-	-	-	-	-	-	-	-	-	-	-	-	-	-	
			7.4	0.13	7.0	0.13	-	-	-	-	-	-	-	-	-	-	-	-	-	-	-	-	-	-
	880	3657	1416	1005	-	-	-	-	-	-	-	-	-	-	-	-	-	-	-	-	-	-	-	-
			8.4	0.14	7.7	0.16	-	-	-	-	-	-	-	-	-	-	-	-	-	-	-	-	-	-
	920	3824	1509	1140	-	-	-	-	-	-	-	-	-	-	-	-	-	-	-	-	-	-	-	-
			9.0	0.16	8.4	0.18	-	-	-	-	-	-	-	-	-	-	-	-	-	-	-	-	-	-
970	4031	1624	1299	500	-	-	-	-	-	-	-	-	-	-	-	-	-	-	-	-	-	-	-	
		9.2	0.19	8.8	0.21	9.1	0.16	-	-	-	-	-	-	-	-	-	-	-	-	-	-	-	-	-
1049	4360	1801	1518	1105	-	-	-	-	-	-	-	-	-	-	-	-	-	-	-	-	-	-	-	
		10.1	0.23	9.8	0.26	10.0	0.26	-	-	-	-	-	-	-	-	-	-	-	-	-	-	-	-	-
1/3	1105	4592	1924	1661	1325	425	-	-	-	-	-	-	-	-	-	-	-	-	-	-	-	-	-	
			10.8	0.27	10.6	0.29	10.6	0.31	10.9	0.22	-	-	-	-	-	-	-	-	-	-	-	-	-	-
1142	4746	2004	1754	1445	776	-	-	-	-	-	-	-	-	-	-	-	-	-	-	-	-	-	-	
		11.1	0.29	10.9	0.32	11.0	0.34	11.3	0.29	-	-	-	-	-	-	-	-	-	-	-	-	-	-	-
1/2	1175	4883	2075	1836	1551	1028	-	-	-	-	-	-	-	-	-	-	-	-	-	-	-	-	-	
			11.5	0.32	11.2	0.35	11.2	0.37	11.7	0.35	-	-	-	-	-	-	-	-	-	-	-	-	-	-
	1200	4987	2128	1897	1626	1212	-	-	-	-	-	-	-	-	-	-	-	-	-	-	-	-	-	
			11.8	0.34	11.6	0.37	11.4	0.39	12.0	0.39	-	-	-	-	-	-	-	-	-	-	-	-	-	-
	1235	5133	2203	1981	1725	1382	470	-	-	-	-	-	-	-	-	-	-	-	-	-	-	-	-	-
			12.1	0.37	12.1	0.40	11.8	0.42	12.4	0.43	12.5	0.31	-	-	-	-	-	-	-	-	-	-	-	-
1280	5320	2298	2085	1846	1543	896	-	-	-	-	-	-	-	-	-	-	-	-	-	-	-	-	-	
		12.4	0.40	12.7	0.44	12.4	0.46	12.7	0.48	13.1	0.42	-	-	-	-	-	-	-	-	-	-	-	-	-
1314	5461	2369	2164	1934	1654	1151	-	-	-	-	-	-	-	-	-	-	-	-	-	-	-	-	-	
		12.6	0.43	13.1	0.47	12.9	0.50	13.1	0.52	13.6	0.49	-	-	-	-	-	-	-	-	-	-	-	-	-
3/4	1340	5569	2423	2224	2000	1738	1343	374	-	-	-	-	-	-	-	-	-	-	-	-	-	-	-	
			12.8	0.46	13.4	0.50	13.3	0.53	13.4	0.55	14.1	0.54	14.0	0.36	-	-	-	-	-	-	-	-	-	-
	1375	5715	2496	2304	2089	1847	1522	737	-	-	-	-	-	-	-	-	-	-	-	-	-	-	-	
			13.1	0.49	13.8	0.53	13.8	0.57	13.8	0.59	14.6	0.59	14.6	0.48	-	-	-	-	-	-	-	-	-	-
	1400	5818	2547	2360	2151	1918	1622	963	-	-	-	-	-	-	-	-	-	-	-	-	-	-	-	-
			13.2	0.52	14.1	0.56	14.1	0.59	14.2	0.62	14.7	0.63	15.0	0.54	-	-	-	-	-	-	-	-	-	-
1435	5964	2620	2439	2238	2017	1738	1228	-	-	-	-	-	-	-	-	-	-	-	-	-	-	-	-	
		13.5	0.56	14.5	0.60	14.6	0.64	14.7	0.66	13.4	0.55	15.7	0.63	-	-	-	-	-	-	-	-	-	-	
1462	6076	2675	2500	2305	2090	1826	1428	564	-	-	-	-	-	-	-	-	-	-	-	-	-	-	-	
		13.9	0.59	14.9	0.63	15.0	0.67	15.1	0.69	15.5	0.71	16.2	0.69	16.1	0.51	-	-	-	-	-	-	-	-	
1511	6280	2775	2609	2422	2217	1984	1686	1029	-	-	-	-	-	-	-	-	-	-	-	-	-	-	-	
		14.7	0.65	15.7	0.69	16.0	0.73	16.0	0.76	16.2	0.78	17.0	0.79	17.0	0.68	-	-	-	-	-	-	-	-	
1	1540	6400	2835	2672	2490	2291	2073	1799	1253	-	-	-	-	-	-	-	-	-	-	-	-	-	-	
			15.0	0.68	15.9	0.73	16.3	0.77	16.3	0.80	16.5	0.82	17.2	0.83	17.6	0.76	-	-	-	-	-	-	-	-
	1586	6592	2928	2772	2597	2408	2204	1950	1593	835	-	-	-	-	-	-	-	-	-	-	-	-	-	
			15.5	0.74	16.3	0.79	16.7	0.83	16.8	0.87	16.9	0.89	17.4	0.91	18.4	0.89	18.3	0.73	-	-	-	-	-	-
1600	6650	2957	2802	2629	2443	2243	1996	1675	964	-	-	-	-	-	-	-	-	-	-	-	-	-		
		15.7	0.76	16.4	0.81	16.9	0.85	16.9	0.89	17.1	0.92	17.6	0.93	18.6	0.93	18.5	0.78	-	-	-	-	-	-	
1639	6812	3036	2886	2719	2540	2349	2121	1850	1285	-	-	-	-	-	-	-	-	-	-	-	-	-		
		16.2	0.81	16.8	0.87	17.3	0.91	17.3	0.95	17.5	0.98	17.9	1.00	18.9	1.00	19.1	0.91	-	-	-	-	-	-	
1 1/2	1675	6961	3109	2963	2801	2629	2442	2236	1981	1552	817	-	-	-	-	-	-	-	-	-	-	-		
			16.7	0.87	17.3	0.92	17.8	0.97	17.8	1.01	17.9	1.04	18.2	1.06	19.0	1.07	19.7	1.02	19.6	0.84	-	-	-	
	1750	7273	3261	3123	2971	2809	2633	2449	2226	1969	1448	701	-	-	-	-	-	-	-	-	-	-		
			18.0	0.98	18.4	1.04	18.8	1.09	18.8	1.14	18.8	1.17	18.8	1.20	19.5	1.22	21.0	1.22	21.0	1.13	21.0	1.38	21.0	1.47
1825	7585	3412	3282	3139	2984	2821	2650	2461	2231	1955	1381	-	-	-	-	-	-	-	-	-	-			
		19.4	1.11	19.7	1.17	19.9	1.22	19.9	1.27	19.8	1.31	19.8	1.34	20.0	1.37	21.0	1.38	22.0	1.38	22.0	1.38	22.0	1.24	
1883	7826	3529	3402	3266	3117	2965	2798	2625	2419	2193	1812	-	-	-	-	-	-	-	-	-	-			
		21.0	1.22	21.0	1.28	21.0	1.33	21.0	1.38	21.0	1.43	21.0	1.46	21.0	1.49	21.0	1.51	22.0	1.53	23.0	1.47			

Performance shown is for installation type A: Free Inlet, Free Outlet. Power rating (BHP) does not include drive losses. For further information on estimating belt drive losses and motor service factors see page 12. The sound ratings shown are for loudness values in fan sones at 5'0" (1.5m) in a hemispherical free field per AMCA Standard 301. Values shown are for installation Type A: free inlet hemispherical sone levels. Performance ratings do not include the effects of appurtenances in the airstream.

FX13B | BELT DRIVE

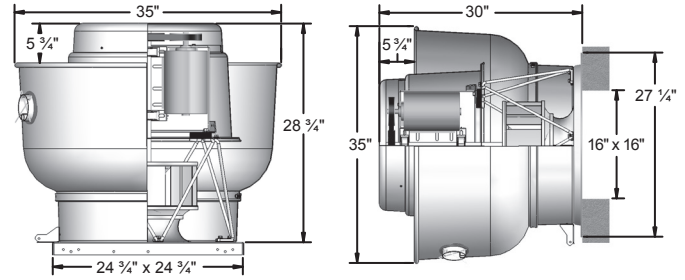
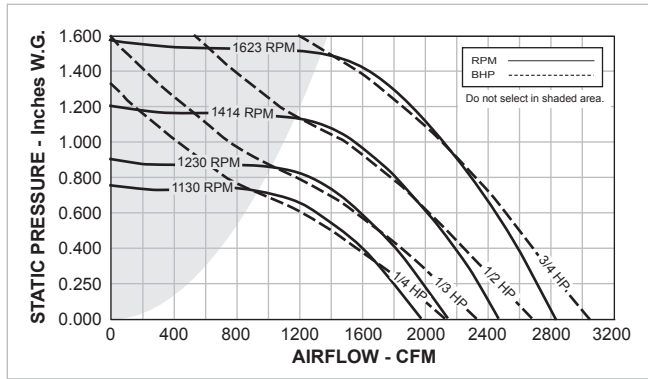

Galv. Steel Base = 16 Gage	Roof/Wall Opening = 16" SQ.	Peak BHP = (RPM/1751) ³
Aluminum Base = 0.064	Damper Size = 15 3/4" SQ.	Max. RPM = 2202 (1 1/2 HP)
Discharge Apron = 0.064	Max. Motor Frame Size = 56	Est. Ship Weight = 110 lbs.*

* Add 8 lbs. for Heat & Smoke option.

HP	RPM	Tip Speed FPM	0.000" SP		0.250" SP		0.375" SP		0.500" SP		0.625" SP		0.750" SP		0.875" SP		1.000" SP		1.250" SP		1.375" SP		
			Sones	BHP	Sones	BHP	Sones	BHP	Sones	BHP	Sones	BHP	Sones	BHP	Sones	BHP	Sones	BHP	Sones	BHP	Sones	BHP	Sones
1/4	500	1800	874	-	-	-	-	-	-	-	-	-	-	-	-	-	-	-	-	-	-	-	-
			6.3	0.02	-	-	-	-	-	-	-	-	-	-	-	-	-	-	-	-	-	-	-
	650	2340	1137	-	-	-	-	-	-	-	-	-	-	-	-	-	-	-	-	-	-	-	-
			7.0	0.04	-	-	-	-	-	-	-	-	-	-	-	-	-	-	-	-	-	-	-
	800	2880	1399	1052	-	-	-	-	-	-	-	-	-	-	-	-	-	-	-	-	-	-	-
			7.6	0.07	7.4	0.09	-	-	-	-	-	-	-	-	-	-	-	-	-	-	-	-	-
	978	3521	1710	1452	1284	1026	-	-	-	-	-	-	-	-	-	-	-	-	-	-	-	-	-
11.0			0.13	10.6	0.16	10.2	0.17	9.7	0.17	-	-	-	-	-	-	-	-	-	-	-	-	-	-
1055	3798	1845	1608	1471	1281	928	-	-	-	-	-	-	-	-	-	-	-	-	-	-	-	-	
		12.7	0.17	12.3	0.20	12.0	0.21	11.5	0.22	10.9	0.21	-	-	-	-	-	-	-	-	-	-	-	-
1130	4068	1976	1755	1635	1485	1281	-	-	-	-	-	-	-	-	-	-	-	-	-	-	-	-	
		13.5	0.20	13.1	0.24	12.9	0.25	12.4	0.26	11.7	0.27	-	-	-	-	-	-	-	-	-	-	-	-
1160	4176	2029	1814	1699	1559	1377	1054	-	-	-	-	-	-	-	-	-	-	-	-	-	-	-	
		13.9	0.22	13.4	0.26	13.2	0.27	12.8	0.28	12.2	0.29	11.6	0.28	-	-	-	-	-	-	-	-	-	-
1185	4266	2072	1862	1751	1619	1448	1196	-	-	-	-	-	-	-	-	-	-	-	-	-	-	-	
		14.3	0.24	13.8	0.27	13.5	0.29	13.1	0.30	12.5	0.31	11.9	0.30	-	-	-	-	-	-	-	-	-	-
1210	4356	2116	1911	1804	1679	1519	1303	-	-	-	-	-	-	-	-	-	-	-	-	-	-	-	
		14.6	0.25	14.1	0.29	13.9	0.30	13.5	0.32	12.9	0.32	12.3	0.33	-	-	-	-	-	-	-	-	-	-
1230	4428	2151	1950	1845	1727	1574	1378	-	-	-	-	-	-	-	-	-	-	-	-	-	-	-	
		15.0	0.26	14.4	0.30	14.2	0.32	13.8	0.33	13.3	0.34	12.6	0.34	-	-	-	-	-	-	-	-	-	-
1255	4518	2195	1998	1895	1782	1639	1458	1152	-	-	-	-	-	-	-	-	-	-	-	-	-	-	
		15.4	0.28	14.8	0.32	14.6	0.34	14.2	0.35	13.6	0.36	13.0	0.37	12.5	0.35	-	-	-	-	-	-	-	-
1280	4608	2239	2046	1945	1835	1701	1535	1292	-	-	-	-	-	-	-	-	-	-	-	-	-	-	
		15.7	0.30	15.2	0.34	14.9	0.35	14.6	0.37	14.0	0.38	13.4	0.39	12.9	0.38	-	-	-	-	-	-	-	-
1305	4698	2282	2094	1994	1889	1762	1606	1401	-	-	-	-	-	-	-	-	-	-	-	-	-	-	
		16.1	0.31	15.6	0.36	15.3	0.37	15.0	0.39	14.4	0.40	13.8	0.41	13.2	0.41	-	-	-	-	-	-	-	-
1330	4788	2326	2142	2044	1942	1823	1676	1493	1130	-	-	-	-	-	-	-	-	-	-	-	-	-	
		16.3	0.33	15.8	0.38	15.5	0.39	15.2	0.41	14.7	0.42	14.1	0.43	13.5	0.44	13.2	0.41	-	-	-	-	-	-
1355	4878	2370	2190	2093	1995	1883	1746	1573	1314	-	-	-	-	-	-	-	-	-	-	-	-	-	
		16.5	0.35	16.0	0.40	15.7	0.41	15.4	0.43	15.0	0.44	14.4	0.45	13.7	0.46	13.4	0.45	-	-	-	-	-	-
1375	4950	2405	2228	2132	2037	1931	1796	1636	1413	-	-	-	-	-	-	-	-	-	-	-	-	-	
		16.7	0.37	16.2	0.41	15.9	0.43	15.6	0.45	15.3	0.46	14.7	0.47	14.0	0.48	13.6	0.48	-	-	-	-	-	-
1400	5040	2449	2275	2181	2089	1985	1858	1708	1516	-	-	-	-	-	-	-	-	-	-	-	-	-	
		16.9	0.39	16.4	0.43	16.2	0.45	15.9	0.47	15.5	0.49	15.0	0.50	14.3	0.50	13.8	0.51	-	-	-	-	-	-
1414	5090	2473	2302	2208	2118	2015	1892	1747	1568	-	-	-	-	-	-	-	-	-	-	-	-	-	
		17.1	0.40	16.6	0.45	16.3	0.47	16.0	0.48	15.7	0.50	15.2	0.51	14.5	0.52	13.9	0.52	-	-	-	-	-	-
1445	5202	2527	2360	2269	2180	2082	1968	1834	1671	-	-	-	-	-	-	-	-	-	-	-	-	-	
		17.4	0.43	16.9	0.47	16.6	0.49	16.4	0.51	16.0	0.53	15.6	0.54	15.0	0.55	14.3	0.56	-	-	-	-	-	-
1470	5292	2571	2408	2317	2230	2135	2028	1903	1749	-	-	-	-	-	-	-	-	-	-	-	-	-	
		17.7	0.45	17.2	0.50	16.9	0.52	16.7	0.54	16.3	0.55	15.9	0.57	15.3	0.58	14.6	0.59	-	-	-	-	-	-
1495	5382	2615	2455	2366	2280	2188	2088	1965	1821	1341	-	-	-	-	-	-	-	-	-	-	-	-	
		18.0	0.47	17.6	0.52	17.3	0.54	17.0	0.56	16.7	0.58	16.3	0.60	15.7	0.60	15.1	0.61	14.4	0.59	-	-	-	-
1525	5490	2667	2511	2424	2339	2251	2156	2039	1906	1521	-	-	-	-	-	-	-	-	-	-	-	-	
		18.5	0.50	18.0	0.55	17.7	0.57	17.4	0.59	17.1	0.61	16.8	0.63	16.2	0.64	15.6	0.65	14.7	0.65	-	-	-	-
1550	5580	2711	2558	2472	2388	2304	2210	2100	1975	1637	-	-	-	-	-	-	-	-	-	-	-	-	
		18.9	0.53	18.4	0.58	18.1	0.60	17.8	0.62	17.6	0.64	17.3	0.66	16.7	0.67	16.1	0.68	15.0	0.69	-	-	-	-
1575	5670	2755	2604	2520	2437	2356	2264	2160	2043	1731	1455	-	-	-	-	-	-	-	-	-	-	-	
		19.3	0.55	18.9	0.61	18.6	0.63	18.3	0.65	18.0	0.67	17.7	0.69	17.3	0.70	16.7	0.71	15.3	0.72	15.3	0.72	15.3	0.70
1600	5760	2798	2651	2568	2486	2406	2317	2220	2105	1818	1597	-	-	-	-	-	-	-	-	-	-	-	
		19.6	0.58	19.2	0.63	18.9	0.66	18.6	0.68	18.3	0.70	18.0	0.72	17.6	0.73	17.0	0.74	15.6	0.76	15.5	0.75	-	-
1623	5842	2839	2694	2612	2531	2452	2366	2275	2161	1892	1707	-	-	-	-	-	-	-	-	-	-	-	
		19.9	0.60	19.4	0.66	19.2	0.68	18.9	0.70	18.6	0.73	18.3	0.74	18.0	0.76	17.3	0.77	16.0	0.79	15.7	0.79	-	-

Performance shown is for installation type A: Free Inlet, Free Outlet. Power rating (BHP) does not include drive losses. For further information on estimating belt drive losses and motor service factors see page 12. The sound ratings shown are for loudness values in fan zones at 5'0" (1.5m) in a hemispherical free field per AMCA Standard 301. Values shown are for installation Type A: free inlet hemispherical sone levels. Performance ratings do not include the effects of appurtenances in the airstream.

FX13BHFT | BELT DRIVE

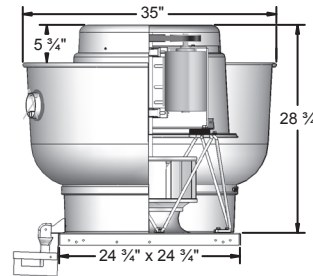
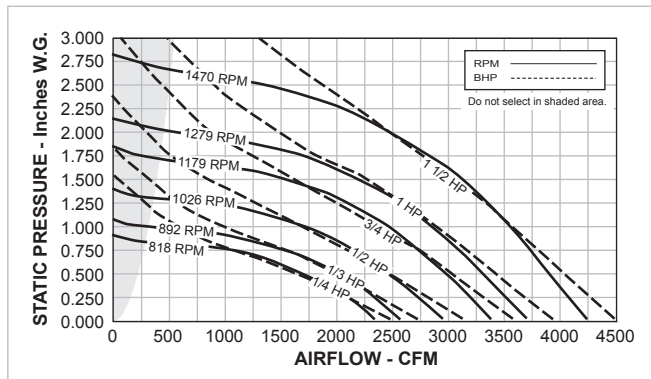

Galv. Steel Base = 16 Gage	Roof/Wall Opening = 16" SQ.	Peak BHP = (RPM/1277) ³
Aluminum Base = 0.064	Damper Size = 15 3/4" SQ.	Max. RPM = 1875 (1 1/2 HP)
Discharge Apron = 0.064	Max. Motor Frame Size = 56	Est. Ship Weight = 115 lbs.*

* Add 8 lbs. for Heat & Smoke option.

HP	RPM	Tip Speed FPM	0.250" SP		0.500" SP		0.750" SP		1.000" SP		1.250" SP		1.500" SP		1.750" SP		2.000" SP		2.250" SP		2.500" SP			
			Sones	BHP	Sones	BHP	Sones	BHP	Sones	BHP	Sones	BHP	Sones	BHP	Sones	BHP	Sones	BHP	Sones	BHP	Sones	BHP	Sones	BHP
1/4	750	3670	1817	1312	-	-	-	-	-	-	-	-	-	-	-	-	-	-	-	-	-	-	-	
	818	4002	2046	1645	915	-	-	-	-	-	-	-	-	-	-	-	-	-	-	-	-	-	-	
1/3	850	4159	2152	1781	1168	-	-	-	-	-	-	-	-	-	-	-	-	-	-	-	-	-	-	
	892	4365	2289	1953	1463	-	-	-	-	-	-	-	-	-	-	-	-	-	-	-	-	-	-	
1/2	925	4526	2395	2080	1641	782	-	-	-	-	-	-	-	-	-	-	-	-	-	-	-	-	-	
	950	4648	2476	2176	1769	1100	-	-	-	-	-	-	-	-	-	-	-	-	-	-	-	-	-	
	975	4771	2554	2270	1888	1298	-	-	-	-	-	-	-	-	-	-	-	-	-	-	-	-	-	
	1000	4893	2630	2360	2006	1483	-	-	-	-	-	-	-	-	-	-	-	-	-	-	-	-	-	
3/4	1026	5020	2709	2451	2119	1666	739	-	-	-	-	-	-	-	-	-	-	-	-	-	-	-	-	
	1050	5138	2782	2534	2218	1798	1104	-	-	-	-	-	-	-	-	-	-	-	-	-	-	-	-	
	1075	5260	2858	2619	2321	1932	1333	-	-	-	-	-	-	-	-	-	-	-	-	-	-	-	-	
	1100	5382	2933	2705	2421	2057	1529	-	-	-	-	-	-	-	-	-	-	-	-	-	-	-	-	
	1125	5505	3008	2788	2518	2177	1708	828	-	-	-	-	-	-	-	-	-	-	-	-	-	-	-	
	1150	5627	3083	2871	2613	2294	1881	1206	-	-	-	-	-	-	-	-	-	-	-	-	-	-	-	
1	1179	5769	3169	2967	2723	2422	2038	1471	-	-	-	-	-	-	-	-	-	-	-	-	-	-	-	
	1200	5872	3232	3036	2802	2510	2150	1636	611	-	-	-	-	-	-	-	-	-	-	-	-	-	-	
	1225	5994	3306	3118	2891	2613	2277	1819	1054	-	-	-	-	-	-	-	-	-	-	-	-	-	-	
	1255	6141	3396	3216	2996	2736	2420	2029	1442	-	-	-	-	-	-	-	-	-	-	-	-	-	-	
1 1/2	1279	6258	3467	3294	3079	2830	2533	2165	1633	569	-	-	-	-	-	-	-	-	-	-	-	-	-	
	1300	6361	3529	3362	3151	2911	2631	2278	1797	972	-	-	-	-	-	-	-	-	-	-	-	-	-	
	1325	6483	3603	3442	3237	3007	2737	2411	1978	1351	-	-	-	-	-	-	-	-	-	-	-	-	-	
	1360	6655	3706	3554	3355	3139	2882	2581	2222	1688	680	-	-	-	-	-	-	-	-	-	-	-	-	
	1400	6850	3824	3677	3489	3288	3046	2770	2438	1997	1355	-	-	-	-	-	-	-	-	-	-	-	-	
	1425	6973	3897	3753	3572	3375	3145	2887	2571	2174	1651	493	-	-	-	-	-	-	-	-	-	-	-	
	1450	7095	3972	3829	3654	3462	3241	2992	2697	2349	1849	1028	-	-	-	-	-	-	-	-	-	-	-	
	1470	7193	4032	3889	3720	3532	3318	3075	2793	2463	1345	-	-	-	-	-	-	-	-	-	-	-	-	
			19.5	1.34	18.7	1.38	17.8	1.42	17.4	1.46	17.1	1.49	16.8	1.51	16.7	1.52	16.6	1.50	16.5	1.43	16.5	1.43	16.5	1.24

Performance shown is for installation type A: Free Inlet, Free Outlet. Power rating (BHP) does not include drive losses. For further information on estimating belt drive losses and motor service factors see page 12. The sound ratings shown are for loudness values in fan zones at 5'0" (1.5m) in a hemispherical free field per AMCA Standard 301. Values shown are for installation Type A: free inlet hemispherical sone levels. Performance ratings do not include the effects of appurtenances in the airstream.

©PENNBARRY 2014

FX14B | BELT DRIVE

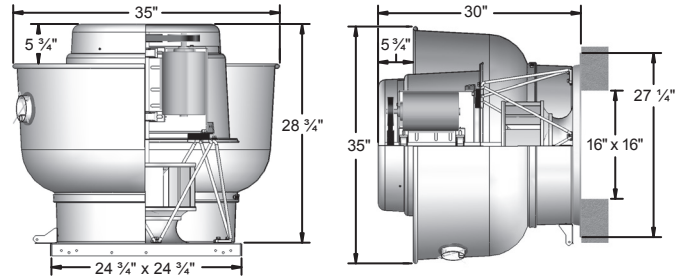
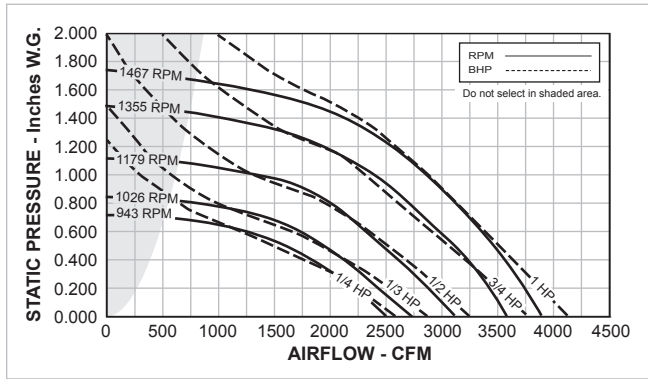

Galv. Steel Base = 16 Gage	Roof/Wall Opening = 16" SQ.	Peak BHP = (RPM/1462) ³
Aluminum Base = 0.064	Damper Size = 15 3/4" SQ.	Max. RPM = 2085 (1 1/2 HP)
Discharge Apron = 0.064	Max. Motor Frame Size = 56	Est. Ship Weight = 112 lbs.*

* Add 11 lbs. for Heat & Smoke option.

HP	RPM	Tip Speed FPM	0.000" SP		0.250" SP		0.500" SP		0.625" SP		0.750" SP		0.875" SP		1.000" SP		1.250" SP		1.375" SP		1.500" SP		
			Sones	BHP	Sones	BHP	Sones	BHP	Sones	BHP	Sones	BHP	Sones	BHP	Sones	BHP	Sones	BHP	Sones	BHP	Sones	BHP	Sones
1/4	400	1662	1061	-	-	-	-	-	-	-	-	-	-	-	-	-	-	-	-	-	-	-	-
			4.8	0.02	-	-	-	-	-	-	-	-	-	-	-	-	-	-	-	-	-	-	-
	550	2286	1459	-	-	-	-	-	-	-	-	-	-	-	-	-	-	-	-	-	-	-	-
			4.9	0.04	-	-	-	-	-	-	-	-	-	-	-	-	-	-	-	-	-	-	-
	690	2868	1830	1283	-	-	-	-	-	-	-	-	-	-	-	-	-	-	-	-	-	-	-
			7.8	0.09	6.9	0.10	-	-	-	-	-	-	-	-	-	-	-	-	-	-	-	-	-
	815	3387	2162	1743	673	-	-	-	-	-	-	-	-	-	-	-	-	-	-	-	-	-	-
10.2			0.14	9.3	0.17	8.0	0.14	-	-	-	-	-	-	-	-	-	-	-	-	-	-	-	-
880	3657	2334	1955	1367	-	-	-	-	-	-	-	-	-	-	-	-	-	-	-	-	-	-	
		11.8	0.18	11.1	0.21	9.8	0.21	-	-	-	-	-	-	-	-	-	-	-	-	-	-	-	-
943	3919	2502	2154	1673	1230	-	-	-	-	-	-	-	-	-	-	-	-	-	-	-	-	-	
		13.0	0.22	12.3	0.26	11.0	0.27	10.4	0.25	-	-	-	-	-	-	-	-	-	-	-	-	-	-
1/3	975	4052	2586	2253	1812	1480	-	-	-	-	-	-	-	-	-	-	-	-	-	-	-	-	
			13.6	0.25	12.8	0.28	11.5	0.30	11.0	0.29	-	-	-	-	-	-	-	-	-	-	-	-	-
			2653	2330	1914	1615	887	-	-	-	-	-	-	-	-	-	-	-	-	-	-	-	-
1000	4156	14.0	0.26	13.3	0.30	12.0	0.32	11.5	0.32	10.8	0.27	-	-	-	-	-	-	-	-	-	-	-	
		2722	2410	2019	1738	1267	-	-	-	-	-	-	-	-	-	-	-	-	-	-	-	-	-
1026	4264	14.3	0.29	13.7	0.32	12.5	0.35	12.0	0.35	11.4	0.32	-	-	-	-	-	-	-	-	-	-	-	
		2785	2483	2110	1850	1504	-	-	-	-	-	-	-	-	-	-	-	-	-	-	-	-	-
1/2	1050	4364	14.7	0.31	14.1	0.35	13.0	0.37	12.4	0.37	12.1	0.36	-	-	-	-	-	-	-	-	-	-	
			2852	2559	2198	1963	1659	838	-	-	-	-	-	-	-	-	-	-	-	-	-	-	-
	1075	4468	15.2	0.33	14.5	0.37	13.4	0.39	12.9	0.40	12.6	0.39	12.2	0.32	-	-	-	-	-	-	-	-	
			2918	2634	2285	2067	1791	1269	-	-	-	-	-	-	-	-	-	-	-	-	-	-	-
	1100	4572	15.8	0.35	15.0	0.39	13.8	0.42	13.3	0.43	13.0	0.43	12.6	0.39	-	-	-	-	-	-	-	-	
			2998	2724	2388	2189	1933	1593	657	-	-	-	-	-	-	-	-	-	-	-	-	-	-
	1130	4696	16.6	0.38	15.9	0.43	14.6	0.45	14.0	0.46	13.5	0.46	13.3	0.44	13.2	0.33	-	-	-	-	-	-	
3077			2812	2490	2309	2072	1786	1147	-	-	-	-	-	-	-	-	-	-	-	-	-	-	
1160	4821	17.4	0.41	16.7	0.46	15.6	0.49	14.9	0.50	14.4	0.50	14.2	0.49	13.9	0.44	-	-	-	-	-	-		
		3128	2867	2553	2377	2157	1889	1394	-	-	-	-	-	-	-	-	-	-	-	-	-	-	
1179	4900	18.1	0.43	17.4	0.48	16.2	0.51	15.6	0.52	15.0	0.52	14.9	0.52	14.7	0.49	-	-	-	-	-	-		
		3210	2956	2654	2485	2284	2038	1718	-	-	-	-	-	-	-	-	-	-	-	-	-	-	
3/4	1210	5029	19.1	0.47	18.4	0.52	17.2	0.55	16.6	0.56	16.1	0.57	15.9	0.57	15.8	0.54	-	-	-	-	-		
			3290	3043	2750	2590	2406	2178	1909	-	-	-	-	-	-	-	-	-	-	-	-	-	
	1240	5154	19.4	0.50	18.7	0.55	17.5	0.59	16.8	0.60	16.3	0.61	16.0	0.61	15.9	0.60	-	-	-	-	-		
			3369	3129	2846	2693	2526	2315	2067	812	-	-	-	-	-	-	-	-	-	-	-		
	1270	5278	19.4	0.54	18.7	0.59	17.6	0.63	17.0	0.64	16.5	0.65	16.0	0.65	15.8	0.65	15.8	0.48	-	-	-		
			3449	3214	2941	2795	2634	2439	2209	1324	-	-	-	-	-	-	-	-	-	-	-		
	1300	5403	19.6	0.58	18.9	0.63	17.9	0.67	17.3	0.69	16.8	0.70	16.2	0.70	15.9	0.70	15.8	0.62	-	-	-		
3528			3300	3035	2893	2738	2561	2349	1698	829	-	-	-	-	-	-	-	-	-	-			
1330	5528	19.9	0.62	19.2	0.68	18.3	0.72	17.7	0.73	17.1	0.74	16.6	0.75	16.2	0.75	15.9	0.71	15.9	0.55	-			
		3595	3371	3113	2974	2825	2662	2464	1938	1241	-	-	-	-	-	-	-	-	-	-			
1355	5631	20.0	0.66	19.6	0.72	18.6	0.76	18.0	0.77	17.5	0.78	17.0	0.79	16.5	0.79	16.1	0.76	16.1	0.67	-			
		3674	3456	3206	3070	2928	2777	2588	2126	1665	817	-	-	-	-	-	-	-	-	-			
1	1385	5756	21.0	0.70	20.0	0.76	19.2	0.80	18.6	0.82	18.0	0.83	17.5	0.85	17.0	0.85	16.3	0.83	16.3	0.79	16.3	0.61	
			3727	3512	3268	3134	2997	2848	2670	2235	1893	1054	-	-	-	-	-	-	-	-	-		
	1405	5839	21.0	0.73	20.0	0.79	19.6	0.84	19.0	0.85	18.5	0.87	17.9	0.88	17.4	0.89	16.6	0.88	16.6	0.79	16.6	0.70	
			3794	3583	3344	3214	3081	2935	2771	2359	2093	1529	-	-	-	-	-	-	-	-	-		
	1430	5943	22.0	0.77	21.0	0.84	20.0	0.88	19.7	0.90	19.1	0.91	18.5	0.93	18.0	0.93	17.0	0.93	16.9	0.90	16.9	0.84	
			3847	3639	3405	3277	3147	3005	2852	2454	2216	1780	-	-	-	-	-	-	-	-	-		
	1450	6026	22.0	0.81	22.0	0.87	21.0	0.91	20.0	0.93	19.6	0.95	19.0	0.96	18.5	0.97	17.4	0.97	17.1	0.96	17.1	0.91	
3892			3687	3457	3331	3202	3063	2919	2533	2309	1972	-	-	-	-	-	-	-	-	-			
1467	6097	23.0	0.83	22.0	0.90	21.0	0.94	21.0	0.97	20.0	0.98	19.5	0.99	19.0	1.01	17.8	1.01	17.4	1.00	17.4	0.96		

Performance shown is for installation type A: Free Inlet, Free Outlet. Power rating (BHP) does not include drive losses. For further information on estimating belt drive losses and motor service factors see page 12. The sound ratings shown are for loudness values in fan sones at 5'0" (1.5m) in a hemispherical free field per AMCA Standard 301. Values shown are for installation Type A: free inlet hemispherical sone levels. Performance ratings do not include the effects of appurtenances in the airstream.

FX16B | BELT DRIVE

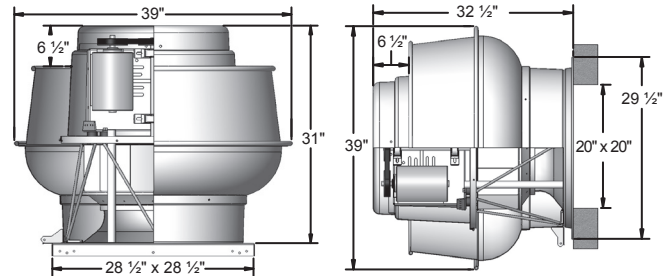
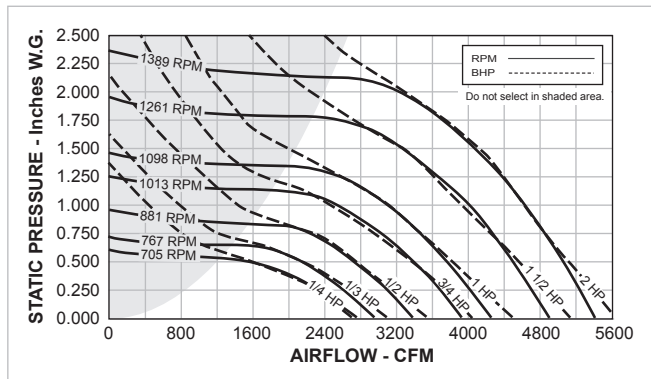

Galv. Steel Base = 14 Gage	Roof/Wall Opening = 20" SQ.	Peak BHP = (RPM/1095) ³
Aluminum Base = 0.080	Damper Size = 19 3/4" SQ.	Max. RPM = 1755 (3 HP)
Discharge Apron = 0.064	Max. Motor Frame Size = 145T	Est. Ship Weight = 144 lbs.*

* Add 11 lbs. for Heat & Smoke option.

HP	RPM	Tip Speed FPM	0.000" SP		0.250" SP		0.500" SP		0.625" SP		0.750" SP		1.000" SP		1.250" SP		1.375" SP		1.500" SP		1.750" SP		
			Sones	BHP	Sones	BHP	Sones	BHP	Sones	BHP	Sones	BHP	Sones	BHP	Sones	BHP	Sones	BHP	Sones	BHP	Sones	BHP	Sones
1/4	500	2446	1999	1280	-	-	-	-	-	-	-	-	-	-	-	-	-	-	-	-	-	-	-
			6.0	0.08	5.2	0.09	-	-	-	-	-	-	-	-	-	-	-	-	-	-	-	-	-
	609	2979	2435	1951	-	-	-	-	-	-	-	-	-	-	-	-	-	-	-	-	-	-	-
			8.8	0.15	8.1	0.17	-	-	-	-	-	-	-	-	-	-	-	-	-	-	-	-	-
1/3	660	3229	2639	2213	-	-	-	-	-	-	-	-	-	-	-	-	-	-	-	-	-	-	
			9.7	0.19	9.2	0.21	-	-	-	-	-	-	-	-	-	-	-	-	-	-	-	-	-
	705	3449	2819	2426	1791	-	-	-	-	-	-	-	-	-	-	-	-	-	-	-	-	-	
			10.7	0.23	10.1	0.26	8.1	0.26	-	-	-	-	-	-	-	-	-	-	-	-	-	-	-
1/2	725	3547	2899	2518	1971	-	-	-	-	-	-	-	-	-	-	-	-	-	-	-	-	-	
			11.1	0.25	10.6	0.28	8.6	0.29	-	-	-	-	-	-	-	-	-	-	-	-	-	-	-
	745	3645	2979	2611	2111	-	-	-	-	-	-	-	-	-	-	-	-	-	-	-	-	-	
			11.6	0.27	11.1	0.30	9.2	0.32	-	-	-	-	-	-	-	-	-	-	-	-	-	-	-
3/4	767	3752	3067	2712	2247	1770	-	-	-	-	-	-	-	-	-	-	-	-	-	-	-		
			12.0	0.30	11.5	0.33	9.8	0.34	8.6	0.33	-	-	-	-	-	-	-	-	-	-	-	-	-
	800	3914	3199	2862	2434	2109	-	-	-	-	-	-	-	-	-	-	-	-	-	-	-		
			12.6	0.34	11.9	0.37	10.5	0.39	9.4	0.39	-	-	-	-	-	-	-	-	-	-	-	-	-
1	830	4061	3319	2997	2596	2342	1791	-	-	-	-	-	-	-	-	-	-	-	-	-			
			13.2	0.38	12.4	0.41	11.2	0.43	10.2	0.44	9.2	0.41	-	-	-	-	-	-	-	-	-	-	
	855	4183	3419	3106	2727	2497	2109	-	-	-	-	-	-	-	-	-	-	-	-	-			
			13.7	0.41	12.9	0.45	11.7	0.47	10.9	0.48	9.8	0.46	-	-	-	-	-	-	-	-	-		
1 1/2	881	4310	3523	3219	2862	2645	2352	-	-	-	-	-	-	-	-	-	-	-	-				
			14.3	0.45	13.5	0.49	12.3	0.51	11.6	0.52	10.6	0.52	-	-	-	-	-	-	-	-			
	920	4501	3679	3387	3062	2860	2635	-	-	-	-	-	-	-	-	-	-	-	-				
			15.3	0.51	14.4	0.55	13.3	0.57	12.6	0.58	11.9	0.60	-	-	-	-	-	-	-				
2	955	4672	3819	3536	3233	3044	2841	2011	-	-	-	-	-	-	-	-	-	-					
			16.3	0.57	15.5	0.61	14.4	0.64	13.7	0.65	13.0	0.66	11.1	0.61	-	-	-	-					
	985	4819	3939	3664	3374	3200	3010	2412	-	-	-	-	-	-	-	-	-						
			17.0	0.63	16.1	0.67	15.0	0.70	14.4	0.71	13.8	0.72	11.8	0.71	-	-	-	-					
3	1013	4956	4051	3783	3505	3344	3160	2678	-	-	-	-	-	-	-	-							
			17.5	0.68	16.6	0.72	15.6	0.76	15.0	0.77	14.4	0.78	12.7	0.79	-	-	-						
	1045	5112	4179	3918	3653	3506	3329	2930	-	-	-	-	-	-	-	-							
			18.2	0.75	17.2	0.79	16.2	0.83	15.7	0.84	15.1	0.85	13.7	0.87	-	-	-						
4	1070	5235	4279	4023	3768	3626	3459	3092	2287	-	-	-	-	-	-								
			18.7	0.81	17.8	0.84	16.8	0.89	16.3	0.90	15.7	0.91	14.4	0.94	12.8	0.86	-						
	1098	5372	4391	4141	3896	3757	3603	3253	2662	-	-	-	-	-									
			19.4	0.87	18.5	0.91	17.7	0.96	17.2	0.97	16.6	0.98	15.3	1.00	13.4	0.98	-						
5	1140	5577	4559	4317	4087	3953	3817	3491	3060	2656	-	-	-										
			21.0	0.97	19.9	1.01	19.1	1.07	18.6	1.08	18.1	1.09	16.9	1.11	15.0	1.13	14.1	1.08					
	1180	5773	4719	4484	4267	4138	4009	3704	3352	3069	2634	-											
			22.0	1.08	21.0	1.12	20.0	1.18	20.0	1.19	19.4	1.20	18.3	1.23	16.8	1.26	15.7	1.24	14.9	1.18			
6	1220	5969	4879	4652	4440	4321	4196	3913	3594	3397	3093	-											
			23.0	1.19	22.0	1.23	22.0	1.29	21.0	1.31	21.0	1.33	19.5	1.35	18.1	1.38	17.3	1.39	16.2	1.36			
	1261	6169	5043	4823	4617	4508	4387	4125	3827	3663	3453	2609											
			24.0	1.32	23.0	1.36	22.0	1.42	22.0	1.44	21.0	1.46	20.0	1.48	19.2	1.51	18.4	1.53	17.5	1.53	16.4	1.39	
7	1295	6335	5179	4965	4764	4661	4544	4299	4012	3858	3687	3102											
			25.0	1.43	24.0	1.47	23.0	1.53	23.0	1.56	22.0	1.57	21.0	1.60	20.0	1.63	19.3	1.65	18.5	1.66	17.0	1.60	
	1330	6507	5318	5111	4913	4817	4704	4475	4197	4055	3900	3452											
			26.0	1.55	25.0	1.59	24.0	1.65	23.0	1.68	23.0	1.70	22.0	1.73	21.0	1.76	20.0	1.77	19.5	1.79	17.7	1.77	
1365	6678	5458	5256	5063	4969	4864	4641	4380	4244	4100	3751												
		26.0	1.67	25.0	1.72	25.0	1.78	24.0	1.81	24.0	1.83	23.0	1.86	22.0	1.89	21.0	1.90	21.0	1.92	18.8	1.94		
1389	6795	5554	5355	5165	5073	4972	4753	4505	4371	4235	3920												
		27.0	1.76	26.0	1.81	25.0	1.87	25.0	1.90	24.0	1.93	23.0	1.96	22.0	1.99	22.0	2.00	21.0	2.02	19.7	2.05		

Performance shown is for installation type A: Free Inlet, Free Outlet. Power rating (BHP) does not include drive losses. For further information on estimating belt drive losses and motor service factors see page 12. The sound ratings shown are for loudness values in fan sones at 5'0" (1.5m) in a hemispherical free field per AMCA Standard 301. Values shown are for installation Type A: free inlet hemispherical sone levels. Performance ratings do not include the effects of appurtenances in the airstream.

©PENNBARRY 2014

FX18B | BELT DRIVE

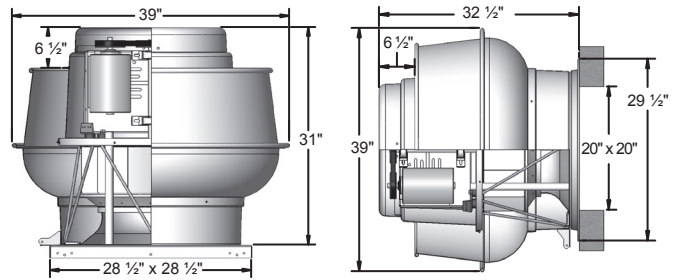
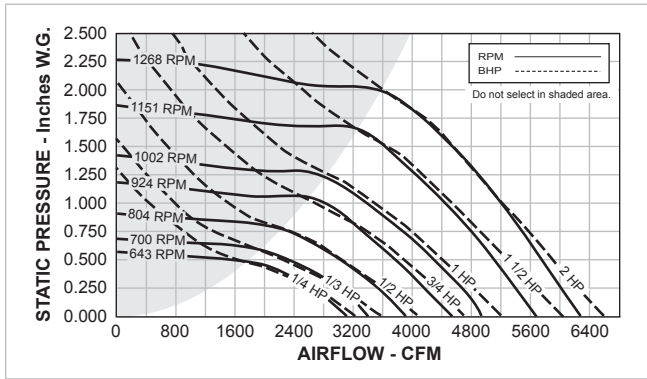

Galv. Steel Base = 14 Gage	Roof/Wall Opening = 20" SQ.	Peak BHP = (RPM/999) ³
Aluminum Base = 0.080	Damper Size = 19 3/4" SQ.	Max. RPM = 1403 (2 HP)
Discharge Apron = 0.064	Max. Motor Frame Size = 145T	Est. Ship Weight = 145 lbs.*

* Add 20 lbs. for Heat & Smoke option.

HP	RPM	Tip Speed FPM	0.000" SP		0.250" SP		0.500" SP		0.625" SP		0.750" SP		1.000" SP		1.250" SP		1.375" SP		1.500" SP		1.750" SP			
			Sones	BHP	Sones	BHP	Sones	BHP	Sones	BHP	Sones	BHP	Sones	BHP	Sones	BHP	Sones	BHP	Sones	BHP	Sones	BHP	Sones	BHP
1/4	400	2121	1984		-		-		-		-		-		-		-		-		-		-	
			4.7	0.05	-		-		-		-		-		-		-		-		-		-	
	556	2948	2758		2050		-		-		-		-		-		-		-		-		-	
			8.9	0.15	7.9	0.17	-		-		-		-		-		-		-		-		-	
1/3	600	3181	2976		2345		-		-		-		-		-		-		-		-		-	
			10.0	0.18	9.0	0.21	-		-		-		-		-		-		-		-		-	
	643	3409	3189		2618		-		-		-		-		-		-		-		-		-	
			11.1	0.23	10.3	0.26	-		-		-		-		-		-		-		-		-	
1/2	665	3525	3299		2755		1885		-		-		-		-		-		-		-		-	
			11.6	0.25	10.8	0.28	9.8	0.28	-		-		-		-		-		-		-		-	
	685	3631	3398		2873		2147		-		-		-		-		-		-		-		-	
			12.0	0.27	11.2	0.31	10.4	0.32	-		-		-		-		-		-		-		-	
3/4	700	3711	3472		2961		2279		-		-		-		-		-		-		-		-	
			12.3	0.29	11.7	0.33	10.7	0.35	-		-		-		-		-		-		-		-	
	730	3870	3621		3136		2503		-		-		-		-		-		-		-		-	
			13.2	0.33	12.6	0.37	11.7	0.39	-		-		-		-		-		-		-		-	
1	760	4029	3770		3309		2716		2328		-		-		-		-		-		-		-	
			14.2	0.37	13.7	0.42	12.8	0.44	12.3	0.44	-		-		-		-		-		-		-	
	785	4162	3894		3452		2890		2569		-		-		-		-		-		-		-	
			15.1	0.41	14.7	0.46	13.9	0.48	13.4	0.49	-		-		-		-		-		-		-	
1 1/2	804	4262	3988		3559		3021		2710		-		-		-		-		-		-		-	
			15.9	0.44	15.5	0.49	14.8	0.52	14.3	0.52	-		-		-		-		-		-		-	
	840	4453	4167		3759		3261		2968		2640		-		-		-		-		-		-	
			16.7	0.50	16.3	0.56	15.6	0.59	15.1	0.59	14.6	0.59	-		-		-		-		-		-	
2	870	4612	4316		3922		3454		3179		2891		-		-		-		-		-		-	
			17.2	0.56	16.8	0.61	16.1	0.65	15.6	0.66	15.1	0.66	-		-		-		-		-		-	
	900	4771	4464		4084		3643		3385		3108		-		-		-		-		-		-	
			17.6	0.62	17.3	0.68	16.6	0.71	16.2	0.72	15.7	0.73	-		-		-		-		-		-	
2	924	4899	4584		4212		3794		3548		3279		-		-		-		-		-		-	
			18.3	0.67	17.8	0.73	17.1	0.76	16.6	0.78	16.1	0.79	-		-		-		-		-		-	
	950	5036	4712		4351		3952		3716		3461		2805		-		-		-		-		-	
			19.2	0.73	18.7	0.79	18.0	0.83	17.4	0.84	16.9	0.86	15.7	0.84	-		-		-		-		-	
2	975	5169	4837		4485		4100		3876		3634		3093		-		-		-		-		-	
			20.0	0.79	19.6	0.85	18.9	0.89	18.3	0.91	17.8	0.92	16.7	0.93	-		-		-		-		-	
	1002	5312	4970		4628		4258		4047		3818		3319		-		-		-		-		-	
			21.0	0.85	20.0	0.92	19.9	0.96	19.4	0.98	18.9	1.00	17.7	1.01	-		-		-		-		-	
2	1040	5513	5159		4829		4479		4285		4067		3595		-		-		-		-		-	
			22.0	0.95	21.0	1.02	21.0	1.07	20.0	1.09	19.7	1.11	18.5	1.13	-		-		-		-		-	
	1080	5726	5357		5039		4709		4525		4322		3878		3357		-		-		-		-	
			22.0	1.07	22.0	1.14	21.0	1.20	21.0	1.21	20.0	1.23	19.3	1.26	18.3	1.26	-		-		-		-	
1120	5938	5556		5249		4937		4759		4574		4156		3709		3364		-		-		-		
		23.0	1.19	23.0	1.26	22.0	1.33	22.0	1.35	21.0	1.36	20.0	1.40	18.9	1.42	18.7	1.39	-		-		-		
2	1151	6102	5710		5411		5113		4940		4767		4368		3935		3696		-		-		-	
			24.0	1.29	23.0	1.37	23.0	1.44	22.0	1.46	22.0	1.47	21.0	1.51	19.5	1.53	19.2	1.53	-		-		-	
	1190	6309	5903		5614		5327		5165		4997		4626		4213		4002		3752		-		-	
			24.0	1.43	24.0	1.51	24.0	1.58	23.0	1.60	23.0	1.62	22.0	1.66	21.0	1.69	20.0	1.70	19.8	1.69	-		-	
1215	6441	6027		5744		5463		5308		5144		4786		4388		4183		3970		-		-		
		25.0	1.52	25.0	1.60	24.0	1.67	24.0	1.70	23.0	1.72	22.0	1.76	21.0	1.79	21.0	1.80	20.0	1.81	-		-		
1245	6600	6176		5899		5625		5479		5319		4977		4597		4397		4195		3541		-		
		26.0	1.64	25.0	1.72	25.0	1.79	25.0	1.83	24.0	1.84	23.0	1.89	22.0	1.92	22.0	1.93	21.0	1.94	21.0	1.87	-		
1268	6722	6290		6019		5749		5610		5453		5123		4755		4558		4362		3850		-		
		26.0	1.73	26.0	1.81	25.0	1.89	25.0	1.92	25.0	1.94	24.0	1.99	23.0	2.03	22.0	2.04	22.0	2.05	21.0	2.03	-		

Performance shown is for installation type A: Free Inlet, Free Outlet. Power rating (BHP) does not include drive losses. For further information on estimating belt drive losses and motor service factors see page 12. The sound ratings shown are for loudness values in fan sones at 5'0" (1.5m) in a hemispherical free field per AMCA Standard 301. Values shown are for installation Type A: free inlet hemispherical sone levels. Performance ratings do not include the effects of appurtenances in the airstream.

FX18BH | BELT DRIVE

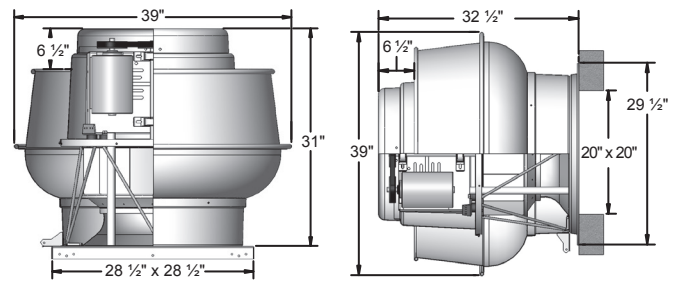
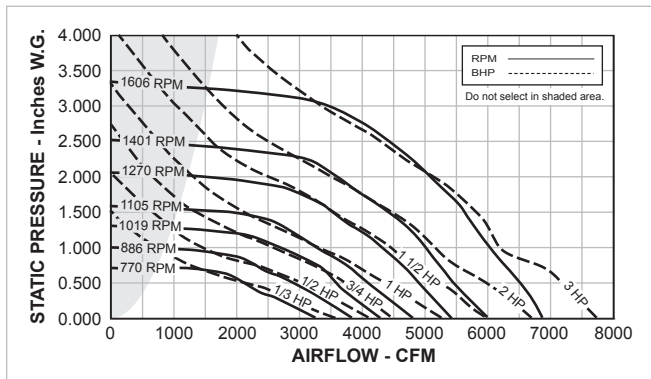

Galv. Steel Base = 14 Gage	Roof/Wall Opening = 20" SQ.	Peak BHP = (RPM/1106) ³
Aluminum Base = 0.080	Damper Size = 19 3/4" SQ.	Max. RPM = 1870 (3 HP)
Discharge Apron = 0.064	Max. Motor Frame Size = 145T	Wall Mounted Max. HP = 2
Est. Ship Weight = 142 lbs. (Add 20 lbs. for Heat & Smoke option.)		

HP	RPM	Tip Speed FPM	0.500" SP		0.750" SP		1.000" SP		1.250" SP		1.500" SP		1.750" SP		2.000" SP		2.250" SP		2.500" SP		3.000" SP			
			Sones	BHP	Sones	BHP	Sones	BHP	Sones	BHP	Sones	BHP	Sones	BHP	Sones	BHP	Sones	BHP	Sones	BHP	Sones	BHP		
1/3	770	4082	2308		-		-		-		-		-		-		-		-		-			
			7.6	0.33	-		-		-		-		-		-		-		-		-			
1/2	800	4241	2520		1622		-		-		-		-		-		-		-		-			
			7.9	0.37	8.1	0.36	-		-		-		-		-		-		-		-			
	840	4453	2773		2108		-		-		-		-		-		-		-		-			
			8.4	0.42	8.9	0.44	-		-		-		-		-		-		-		-			
886	4697	3028		2436		-		-		-		-		-		-		-		-		-		
		9.4	0.48	9.4	0.52	-		-		-		-		-		-		-		-		-		
3/4	915	4851	3186		2628		1676		-		-		-		-		-		-		-		-	
			10.1	0.53	9.9	0.57	10.0	0.52	-		-		-		-		-		-		-		-	
	970	5142	3475		3017		2435		-		-		-		-		-		-		-		-	
11.5			0.62	10.7	0.66	11.5	0.68	-		-		-		-		-		-		-		-		
1	1019	5402	3712		3342		2786		1779		-		-		-		-		-		-		-	
			12.4	0.71	11.3	0.75	12.0	0.79	12.1	0.71	-		-		-		-		-		-		-	
	1065	5646	3932		3598		3093		2515		-		-		-		-		-		-		-	
			13.0	0.81	11.9	0.85	12.4	0.89	13.3	0.88	-		-		-		-		-		-		-	
1080	5726	4003		3681		3200		2675		-		-		-		-		-		-		-		
		13.2	0.84	12.2	0.88	12.5	0.93	13.6	0.93	-		-		-		-		-		-		-		
1105	5858	4121		3818		3378		2884		1361		-		-		-		-		-		-		
		13.5	0.90	12.6	0.93	12.7	0.98	13.7	1.00	13.4	0.73	-		-		-		-		-		-		
1 1/2	1125	5964	4216		3926		3519		3019		2151		-		-		-		-		-		-	
			13.9	0.94	12.9	0.98	12.8	1.03	13.9	1.06	14.1	0.98	-		-		-		-		-		-	
	1150	6097	4333		4061		3693		3186		2575		-		-		-		-		-		-	
			14.2	1.00	13.4	1.04	13.0	1.09	14.1	1.13	14.8	1.10	-		-		-		-		-		-	
	1175	6229	4450		4193		3850		3352		2844		-		-		-		-		-		-	
			14.7	1.07	14.0	1.11	13.3	1.15	14.3	1.20	15.5	1.19	-		-		-		-		-		-	
	1200	6362	4570		4315		3990		3525		3088		1920		-		-		-		-		-	
			15.3	1.13	14.5	1.17	13.6	1.22	14.6	1.28	15.7	1.29	15.5	1.11	-		-		-		-		-	
1225	6494	4697		4436		4129		3703		3258		2544		-		-		-		-		-		
		16.1	1.18	15.2	1.24	14.3	1.29	14.9	1.34	16.0	1.37	16.4	1.3	-		-		-		-		-		
1270	6733	4925		4652		4376		4019		3559		3081		-		-		-		-		-		
		17.0	1.29	16.2	1.38	15.3	1.42	15.3	1.47	16.5	1.52	17.7	1.51	-		-		-		-		-		
2	1280	6786	4975		4700		4430		4089		3625		3188		1895		-		-		-		-	
			17.1	1.32	16.3	1.41	15.5	1.45	15.4	1.50	16.6	1.56	17.9	1.55	17.3	1.28	-		-		-		-	
	1335	7077	5251		4961		4728		4424		4008		3599		3051		-		-		-		-	
			18.4	1.46	17.2	1.58	16.6	1.63	16.1	1.68	17.1	1.74	18.4	1.77	19.2	1.73	-		-		-		-	
1375	7289	5449		5150		4931		4646		4290		3865		3478		2571		-		-		-		
		19.4	1.57	18.2	1.72	17.6	1.77	17.1	1.82	17.5	1.88	18.8	1.93	20.0	1.93	19.9	1.78	-		-		-		
1401	7427	5578		5272		5057		4789		4471		4036		3670		3073		-		-		-		
		20.0	1.64	18.8	1.82	18.2	1.86	17.8	1.91	17.9	1.97	19.1	2.04	20.0	2.05	21.0	1.98	-		-		-		
3	1440	7634	5770		5454		5245		5002		4720		4315		3933		3494		2481		-		-	
			21.0	1.76	19.8	1.96	19.3	2.01	18.8	2.06	18.7	2.12	19.6	2.19	21.0	2.22	22.0	2.20	22.0	1.98	-		-	
	1480	7846	5958		5650		5436		5218		4944		4598		4198		3852		3274		-		-	
			22.0	1.89	21.0	2.11	20.0	2.17	20.0	2.22	19.7	2.28	20.0	2.35	21.0	2.41	23.0	2.41	23.0	2.34	-		-	
	1520	8058	6139		5853		5627		5428		5165		4876		4474		4122		3705		-		-	
			24.0	2.03	22.0	2.24	22.0	2.34	21.0	2.39	21.0	2.45	21.0	2.51	22.0	2.59	23.0	2.61	25.0	2.59	-		-	
	1560	8270	6321		6055		5816		5623		5385		5124		4759		4389		4060		1714		-	
			25.0	2.19	24.0	2.39	23.0	2.52	23.0	2.57	23.0	2.63	22.0	2.69	23.0	2.77	24.0	2.82	25.0	2.83	24.0	1.93	-	
1585	8403	6434		6181		5934		5744		5520		5264		4935		4553		4230		2907		-		
		26.0	2.28	25.0	2.48	24.0	2.64	24.0	2.69	23.0	2.75	23.0	2.81	23.0	2.88	24.0	2.96	26.0	2.96	26.0	2.71	-		
1606	8514	6528		6286		6032		5845		5634		5381		5081		4700		4371		3378		-		
		27.0	2.37	25.0	2.56	24.0	2.74	24.0	2.79	24.0	2.85	24.0	2.91	24.0	2.98	25.0	3.06	26.0	3.08	27.0	2.95	-		

Performance shown is for installation type A: Free Inlet, Free Outlet. Power rating (BHP) does not include drive losses. For further information on estimating belt drive losses and motor service factors see page 12. The sound ratings shown are for loudness values in fan sones at 5'0" (1.5m) in a hemispherical free field per AMCA Standard 301. Values shown are for installation Type A: free inlet hemispherical sone levels. Performance ratings do not include the effects of appurtenances in the airstream.

FX24B | BELT DRIVE

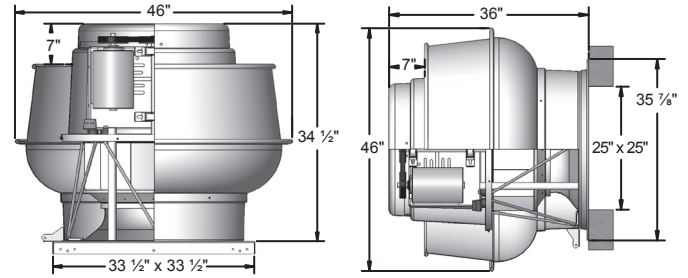
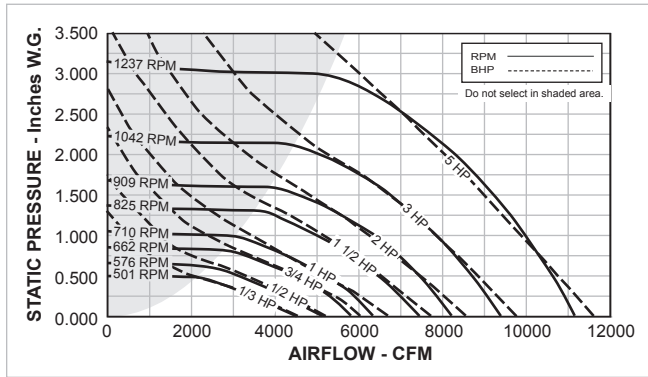

Galv. Steel Base = 14 Gage	Roof/Wall Opening = 25" SQ.	Peak BHP = (RPM/716) ³
Aluminum Base = 0.080	Damper Size = 24 3/4" SQ.	Max. RPM = 1360 (5 HP)
Discharge Apron = 0.064	Max. Motor Frame Size = 184T	Wall Mounted Max. HP = 2
Est. Ship Weight = 190 lbs. (Add 40 lbs. for Heat & Smoke option.)		

HP	RPM	Tip Speed FPM	0.250" SP		0.500" SP		0.750" SP		1.000" SP		1.250" SP		1.500" SP		1.750" SP		2.000" SP		2.250" SP		2.500" SP		
			Sones	BHP	Sones	BHP	Sones	BHP	Sones	BHP	Sones	BHP	Sones	BHP	Sones	BHP	Sones	BHP	Sones	BHP	Sones	BHP	Sones
1/4	375	2436	1.986	-	-	-	-	-	-	-	-	-	-	-	-	-	-	-	-	-	-	-	-
			5.9	0.14	-	-	-	-	-	-	-	-	-	-	-	-	-	-	-	-	-	-	-
	420	2728	2.701	-	-	-	-	-	-	-	-	-	-	-	-	-	-	-	-	-	-	-	-
1/3	461	2995	3.245	-	-	-	-	-	-	-	-	-	-	-	-	-	-	-	-	-	-	-	-
			8.7	0.27	-	-	-	-	-	-	-	-	-	-	-	-	-	-	-	-	-	-	-
	480	3118	3.471	-	-	-	-	-	-	-	-	-	-	-	-	-	-	-	-	-	-	-	-
1/2	501	3255	3.717	-	-	-	-	-	-	-	-	-	-	-	-	-	-	-	-	-	-	-	-
			10.4	0.34	-	-	-	-	-	-	-	-	-	-	-	-	-	-	-	-	-	-	-
	540	3508	4.163	2.992	-	-	-	-	-	-	-	-	-	-	-	-	-	-	-	-	-	-	-
3/4	576	3742	4.543	3.557	-	-	-	-	-	-	-	-	-	-	-	-	-	-	-	-	-	-	-
			12.9	0.51	11.7	0.52	-	-	-	-	-	-	-	-	-	-	-	-	-	-	-	-	-
	610	3963	4.896	4.036	-	-	-	-	-	-	-	-	-	-	-	-	-	-	-	-	-	-	-
1	640	4157	5.203	4.433	3.236	-	-	-	-	-	-	-	-	-	-	-	-	-	-	-	-	-	-
			14.9	0.69	14.0	0.72	12.8	0.67	-	-	-	-	-	-	-	-	-	-	-	-	-	-	-
	662	4300	5.421	4.709	3.676	-	-	-	-	-	-	-	-	-	-	-	-	-	-	-	-	-	-
1 1/2	690	4482	5.697	5.040	4.126	-	-	-	-	-	-	-	-	-	-	-	-	-	-	-	-	-	-
			16.2	0.85	15.4	0.89	14.3	0.89	-	-	-	-	-	-	-	-	-	-	-	-	-	-	-
	718	4664	5.972	5.367	4.542	3.116	-	-	-	-	-	-	-	-	-	-	-	-	-	-	-	-	-
2	755	4905	6.332	5.791	5.049	4.070	-	-	-	-	-	-	-	-	-	-	-	-	-	-	-	-	-
			18.2	1.10	17.4	1.16	16.4	1.18	15.3	1.12	-	-	-	-	-	-	-	-	-	-	-	-	-
	790	5132	6.670	6.167	5.510	4.663	-	-	-	-	-	-	-	-	-	-	-	-	-	-	-	-	-
3	825	5359	7.007	6.534	5.937	5.185	4.151	-	-	-	-	-	-	-	-	-	-	-	-	-	-	-	-
			21.0	1.42	19.9	1.49	19.0	1.53	18.0	1.53	16.8	1.43	-	-	-	-	-	-	-	-	-	-	-
	850	5522	7.246	6.793	6.231	5.538	4.660	-	-	-	-	-	-	-	-	-	-	-	-	-	-	-	-
4	880	5717	7.532	7.103	6.580	5.939	5.165	3.845	-	-	-	-	-	-	-	-	-	-	-	-	-	-	-
			22.0	1.71	21.0	1.79	20.0	1.84	19.3	1.87	18.3	1.83	17.3	1.63	-	-	-	-	-	-	-	-	-
	909	5905	7.808	7.397	6.913	6.321	5.599	4.660	-	-	-	-	-	-	-	-	-	-	-	-	-	-	-
5	950	6171	8.197	7.803	7.367	6.824	6.187	5.435	4.130	-	-	-	-	-	-	-	-	-	-	-	-	-	-
			25.0	2.14	25.0	2.23	24.0	2.30	23.0	2.34	22.0	2.35	21.0	2.29	19.3	2.05	-	-	-	-	-	-	-
	985	6399	8.527	8.148	7.736	7.236	6.655	5.973	5.102	-	-	-	-	-	-	-	-	-	-	-	-	-	-
6	1015	6593	8.809	8.441	8.050	7.585	7.050	6.417	5.681	4.389	-	-	-	-	-	-	-	-	-	-	-	-	-
			29.0	2.59	28.0	2.69	27.0	2.78	26.0	2.83	25.0	2.86	24.0	2.86	23.0	2.77	22.0	2.49	-	-	-	-	-
	1042	6769	9.062	8.705	8.330	7.896	7.390	6.795	6.123	5.217	-	-	-	-	-	-	-	-	-	-	-	-	-
7	1100	7146	9.605	9.267	8.927	8.539	8.076	7.568	6.985	6.327	5.393	-	-	-	-	-	-	-	-	-	-	-	-
			30.0	3.28	30.0	3.39	29.0	3.50	28.0	3.57	27.0	3.62	26.0	3.65	25.0	3.64	24.0	3.56	23.0	3.35	-	-	-
	1150	7470	10.071	9.749	9.424	9.065	8.656	8.197	7.669	7.085	6.427	5.428	-	-	-	-	-	-	-	-	-	-	-
	1200	7795	32.0	3.74	31.0	3.85	30.0	3.96	29.0	4.05	28.0	4.11	27.0	4.16	26.0	4.17	25.0	4.13	25.0	4.02	24.0	3.77	-
8	1237	8036	10.536	10.228	9.916	9.586	9.227	8.788	8.330	7.804	7.221	6.552	-	-	-	-	-	-	-	-	-	-	-
			34.0	4.23	33.0	4.35	33.0	4.47	32.0	4.57	31.0	4.65	30.0	4.70	29.0	4.73	28.0	4.73	27.0	4.67	26.0	4.53	-
9	1237	8036	10.879	10.581	10.279	9.968	9.623	9.219	8.793	8.300	7.770	7.190	-	-	-	-	-	-	-	-	-	-	-
			36.0	4.63	35.0	4.75	35.0	4.87	34.0	4.99	33.0	5.07	32.0	5.13	31.0	5.18	30.0	5.18	29.0	5.16	28.0	5.08	-

Performance shown is for installation type A: Free Inlet, Free Outlet. Power rating (BHP) does not include drive losses. For further information on estimating belt drive losses and motor service factors see page 12. The sound ratings shown are for loudness values in fan sones at 5'0" (1.5m) in a hemispherical free field per AMCA Standard 301. Values shown are for installation Type A: free inlet hemispherical sone levels. Performance ratings do not include the effects of appurtenances in the airstream.

FX24BH | BELT DRIVE

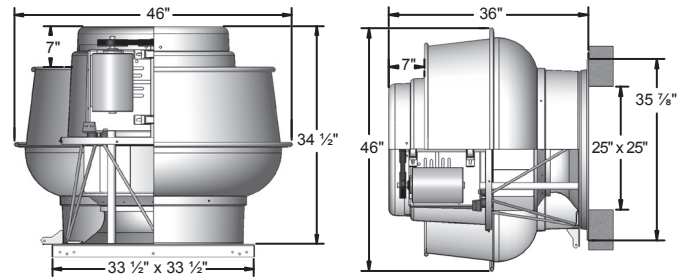
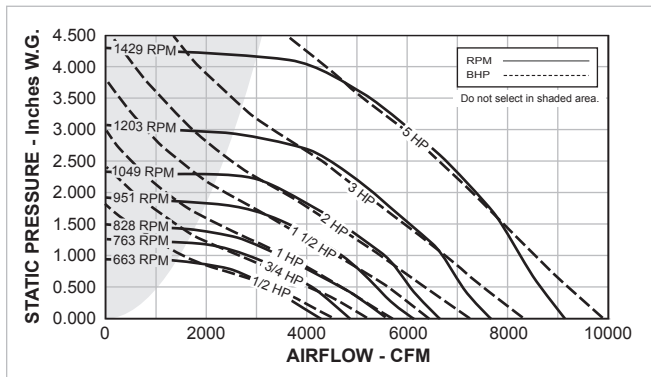

Galv. Steel Base = 14 Gage	Roof Opening = 25" SQ.	Peak BHP = (RPM/827) ³
Aluminum Base = 0.080	Damper Size = 24 3/4" SQ.	Max. RPM = 1620 (5 HP)
Discharge Apron = 0.064	Max. Motor Frame Size = 184T	Wall Mounted Max. HP = 2
Est. Ship Weight = 187 lbs. (Add 40 lbs. for Heat & Smoke option.)		

HP	RPM	Tip Speed FPM	0.500" SP		0.750" SP		1.000" SP		1.250" SP		1.500" SP		1.750" SP		2.000" SP		2.250" SP		2.500" SP		3.000" SP					
			Sones	BHP	Sones	BHP	Sones	BHP	Sones	BHP	Sones	BHP	Sones	BHP	Sones	BHP	Sones	BHP	Sones	BHP	Sones	BHP	Sones	BHP		
1/2	600	3897	2641		-		-		-		-		-		-		-		-		-		-			
			8.9	0.38	-		-		-		-		-		-		-		-		-		-		-	
1/2	663	4306	3231		2472		-		-		-		-		-		-		-		-		-			
			10.0	0.51	10.3	0.51	-		-		-		-		-		-		-		-		-		-	
3/4	707	4592	3633		2971		1877		-		-		-		-		-		-		-		-			
			10.8	0.61	11.0	0.63	10.8	0.56	-		-		-		-		-		-		-		-		-	
			11.1	0.65	11.3	0.67	11.4	0.64	-		-		-		-		-		-		-		-		-	
3/4	725	4709	3774		3142		2264		-		-		-		-		-		-		-		-			
			11.1	0.65	11.3	0.67	11.4	0.64	-		-		-		-		-		-		-		-		-	
			11.9	0.75	12.0	0.78	12.3	0.78	-		-		-		-		-		-		-		-		-	
3/4	763	4956	4069		3497		2824		-		-		-		-		-		-		-		-			
			11.9	0.75	12.0	0.78	12.3	0.78	-		-		-		-		-		-		-		-		-	
			12.7	0.94	12.8	0.98	12.9	1.00	13.4	0.98	-		-		-		-		-		-		-		-	
1	800	5196	4351		3844		3259		2352		-		-		-		-		-		-		-			
			12.4	0.86	12.5	0.89	12.6	0.91	12.7	0.85	-		-		-		-		-		-		-		-	
1	828	5378	4549		4107		3542		2822		-		-		-		-		-		-		-			
			12.7	0.94	12.8	0.98	12.9	1.00	13.4	0.98	-		-		-		-		-		-		-		-	
1 1/2	855	5553	4736		4357		3796		3180		1929		-		-		-		-		-		-			
			13.1	1.03	13.1	1.07	13.3	1.10	13.6	1.09	13.3	0.93	-		-		-		-		-		-		-	
	886	5755	4950		4607		4083		3546		2740		-		-		-		-		-		-			
			13.7	1.13	13.7	1.19	13.7	1.22	14.0	1.23	14.3	1.17	-		-		-		-		-		-		-	
	915	5943	5148		4833		4355		3857		3223		-		-		-		-		-		-			
14.7			1.23	14.6	1.30	14.6	1.34	14.6	1.35	14.9	1.33	-		-		-		-		-		-		-		
925	6008	5216		4910		4450		3953		3345		2152		-		-		-		-		-				
		15.2	1.27	15.0	1.34	15.0	1.38	14.9	1.40	15.0	1.38	14.8	1.20	-		-		-		-		-		-		
951	6177	5393		5110		4695		4198		3655		2859		-		-		-		-		-				
		16.0	1.37	15.7	1.45	15.7	1.49	15.6	1.51	15.5	1.51	15.8	1.43	-		-		-		-		-		-		
2	990	6430	5657		5403		5056		4560		4107		3503		2353		-		-		-		-			
			16.9	1.53	16.5	1.62	16.5	1.67	16.5	1.70	16.5	1.72	16.7	1.69	16.5	1.48	-		-		-		-		-	
			17.4	1.66	16.9	1.75	16.9	1.81	16.9	1.85	17.0	1.87	17.2	1.85	17.5	1.76	-		-		-		-		-	
2	1019	6619	5856		5605		5288		4831		4384		3851		3096		-		-		-		-			
			17.4	1.66	16.9	1.75	16.9	1.81	16.9	1.85	17.0	1.87	17.2	1.85	17.5	1.76	-		-		-		-		-	
			18.0	1.80	17.4	1.89	17.4	1.96	17.4	2.00	17.5	2.03	17.8	2.04	18.3	1.99	17.9	1.75	-		-		-		-	
3	1049	6814	6063		5813		5522		5115		4667		4203		3597		2447		-		-		-			
			18.0	1.80	17.4	1.89	17.4	1.96	17.4	2.00	17.5	2.03	17.8	2.04	18.3	1.99	17.9	1.75	-		-		-		-	
	1080	7015	6276		6027		5761		5405		4954		4539		4005		3270		-		-		-			
			18.8	1.95	18.0	2.05	18.0	2.13	18.0	2.18	18.1	2.21	18.4	2.23	18.8	2.20	19.1	2.10	-		-		-		-	
	1105	7177	6447		6198		5953		5635		5184		4777		4301		2689		2546		-		-		-	
19.5			2.08	18.6	2.18	18.6	2.32	18.6	2.32	18.6	2.36	18.9	2.38	19.3	2.73	19.9	2.31	19.4	2.03	-		-		-		
20.0			2.19	19.3	2.29	19.1	2.39	19.1	2.44	19.1	2.48	19.3	2.51	19.7	2.51	20.0	2.48	20.0	2.32	-		-		-		
1175	7632	6923		6675		6461		6191		5846		5429		5047		4597		4058		-		-		-		
		22.0	2.48	21.0	2.58	21.0	2.69	21.0	2.75	21.0	2.80	20.0	2.84	21.0	2.86	21.0	2.85	22.0	2.80	-		-		-		
1203	7814	7122		6864		6655		6407		6105		5690		5311		4924		4425		-		-		-		
		23.0	2.65	22.0	2.76	21.0	2.86	21.0	2.94	21.0	3.00	21.0	3.04	21.0	3.07	22.0	3.08	22.0	3.04	-		-		-		
5	1210	7859	7160		6911		6704		6461		6169		5757		5377		5004		4508		2767		-			
			23.0	2.69	22.0	2.80	21.0	2.91	21.0	2.99	21.0	3.05	21.0	3.09	21.0	3.12	22.0	3.14	22.0	3.10	22.0	2.65	-		-	
	1245	8087	7395		7152		6945		6728		6453		6088		5701		5341		4922		3740		-			
			24.0	2.92	23.0	3.03	22.0	3.14	22.0	3.24	22.0	3.30	22.0	3.35	22.0	3.39	22.0	3.41	23.0	3.40	24.0	3.21	-		-	
	1275	8281	7597		7359		7151		6954		6688		6368		5977		5624		5270		4244		-			
			24.0	3.12	23.0	3.24	23.0	3.35	23.0	3.47	23.0	3.53	22.0	3.58	23.0	3.63	23.0	3.65	23.0	3.67	25.0	3.54	-		-	
	1325	8606	7931		7702		7492		7302		7074		6815		6453		6088		5750		4933		-			
25.0			3.49	24.0	3.61	24.0	3.73	23.0	3.84	23.0	3.93	23.0	3.99	23.0	4.04	24.0	4.08	24.0	4.10	26.0	4.07	-		-		
1380	8963	8298		8078		7865		7683		7493		7246		6965		6604		6264		5580		-				
		27.0	3.92	26.0	4.04	25.0	4.17	25.0	4.29	25.0	4.41	25.0	4.47	25.0	4.53	25.0	4.58	25.0	4.62	26.0	4.64	-		-		
1429	9282	8623		8411		8198		8019		7843		7624		7384		7065		6717		6086		-				
		29.0	4.33	28.0	4.46	27.0	4.59	26.0	4.72	26.0	4.84	26.0	4.93	26.0	5.05	26.0	5.05	27.0	5.16	-		-		-		

Performance shown is for installation type A: Free Inlet, Free Outlet. Power rating (BHP) does not include drive losses. For further information on estimating belt drive losses and motor service factors see page 12. The sound ratings shown are for loudness values in fan sones at 5'0" (1.5m) in a hemispherical free field per AMCA Standard 301. Values shown are for installation Type A: free inlet hemispherical sone levels. Performance ratings do not include the effects of appurtenances in the airstream.

FX27B | BELT DRIVE

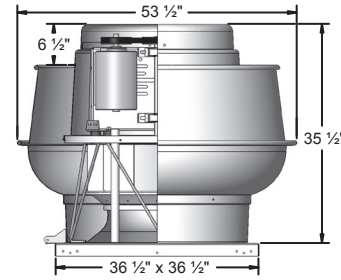
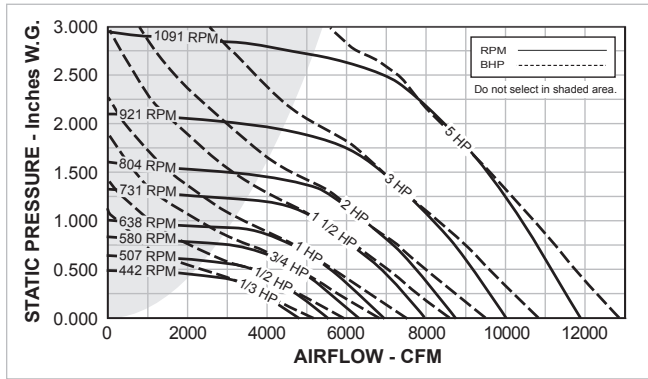

Galv. Steel Base = 14 Gage	Roof Opening = 28" SQ.	Peak BHP = (RPM/539) ³
Aluminum Base = 0.080	Damper Size = 27 3/4" SQ.	Max. RPM = 1188 (5 HP)
Discharge Apron = 0.080	Max. Motor Frame Size = 184T	Est. Ship Weight = 219 lbs.*

* Add 55 lbs. for Heat & Smoke option.

HP	RPM	Tip Speed FPM	0.125" SP		0.250" SP		0.375" SP		0.500" SP		0.750" SP		1.000" SP		1.250" SP		1.500" SP		2.000" SP	
			Sones	BHP	Sones	BHP	Sones	BHP	Sones	BHP	Sones	BHP	Sones	BHP	Sones	BHP	Sones	BHP	Sones	BHP
1/3	442	3211	4361	-	3843	-	3112	-	-	-	-	-	-	-	-	-	-	-	-	-
			8.3	0.30	7.7	0.33	7.1	0.33	-	-	-	-	-	-	-	-	-	-	-	-
1/2	475	3451	4780	-	4293	-	3695	2634	-	-	-	-	-	-	-	-	-	-	-	-
			9.7	0.37	9.0	0.40	8.6	0.41	7.6	0.38	-	-	-	-	-	-	-	-	-	-
1/2	507	3683	5120	-	4710	-	4213	3530	-	-	-	-	-	-	-	-	-	-	-	-
			10.7	0.44	10.1	0.48	9.8	0.50	9.2	0.49	-	-	-	-	-	-	-	-	-	-
3/4	535	3887	5444	-	5065	-	4617	4030	-	-	-	-	-	-	-	-	-	-	-	-
			11.7	0.51	11.1	0.55	10.7	0.58	10.3	0.59	-	-	-	-	-	-	-	-	-	-
3/4	560	4068	4361	-	4361	-	4361	4361	-	-	-	-	-	-	-	-	-	-	-	-
			12.7	0.59	12.2	0.63	11.7	0.66	11.5	0.67	-	-	-	-	-	-	-	-	-	-
3/4	580	4214	5960	-	5628	-	5234	4785	3159	-	-	-	-	-	-	-	-	-	-	-
			13.5	0.65	13.1	0.69	12.7	0.73	12.5	0.75	10.9	0.69	-	-	-	-	-	-	-	-
1	600	4359	6188	-	5870	-	5498	5076	3889	-	-	-	-	-	-	-	-	-	-	-
			14.2	0.71	13.8	0.76	13.4	0.80	13.2	0.82	12.0	0.80	-	-	-	-	-	-	-	-
1	620	4504	6415	-	6107	-	5756	5363	4304	-	-	-	-	-	-	-	-	-	-	-
			14.9	0.78	14.6	0.83	14.2	0.87	13.8	0.90	12.9	0.90	-	-	-	-	-	-	-	-
1	638	4635	6631	-	6330	-	5990	5625	4635	-	-	-	-	-	-	-	-	-	-	-
			15.4	0.85	15.0	0.90	14.6	0.94	14.3	0.98	13.5	0.99	-	-	-	-	-	-	-	-
1 1/2	660	4795	6868	-	6577	-	6264	5913	5018	-	-	-	-	-	-	-	-	-	-	-
			15.9	0.94	15.7	0.99	15.2	1.04	14.8	1.07	14.2	1.10	-	-	-	-	-	-	-	-
1 1/2	685	4976	7150	-	6869	-	6578	6248	5461	4209	-	-	-	-	-	-	-	-	-	-
			16.7	1.04	16.4	1.10	16.0	1.15	15.6	1.19	15.0	1.24	13.8	1.17	-	-	-	-	-	-
1 1/2	705	5122	7374	-	7101	-	6827	6506	5782	4753	-	-	-	-	-	-	-	-	-	-
			17.4	1.13	17.1	1.19	16.7	1.24	16.3	1.29	15.7	1.34	14.7	1.31	-	-	-	-	-	-
1 1/2	731	5311	7666	-	7403	-	7144	6839	6161	5247	-	-	-	-	-	-	-	-	-	-
			18.4	1.26	18.1	1.32	17.7	1.38	17.4	1.42	16.7	1.49	15.8	1.48	-	-	-	-	-	-
2	750	5449	7879	-	7622	-	7369	7080	6434	5583	4127	-	-	-	-	-	-	-	-	-
			19.0	1.35	18.7	1.42	18.4	1.48	18.0	1.53	17.4	1.60	16.6	1.61	15.0	1.49	-	-	-	-
2	770	5594	8103	-	7853	-	7605	7332	6719	5932	4856	-	-	-	-	-	-	-	-	-
			19.6	1.46	19.3	1.53	18.9	1.59	18.5	1.64	17.9	1.72	17.3	1.76	16.0	1.67	-	-	-	-
2	785	5703	8270	-	8025	-	7782	7521	6925	6200	5250	-	-	-	-	-	-	-	-	-
			20.0	1.54	19.8	1.62	19.4	1.68	18.9	1.73	18.3	1.82	17.8	1.86	16.6	1.81	-	-	-	-
2	804	5841	8482	-	8243	-	8004	7758	7183	6528	5628	-	-	-	-	-	-	-	-	-
			21.0	1.66	20.0	1.73	19.9	1.80	19.5	1.85	18.8	1.94	18.4	2.00	17.3	1.97	-	-	-	-
3	830	6030	8772	-	8540	-	8308	8080	7534	6910	6092	4830	-	-	-	-	-	-	-	-
			22.0	1.82	21.0	1.89	21.0	1.97	22.0	2.00	19.6	2.12	18.9	2.18	18.1	2.18	16.9	2.05	-	-
3	865	6284	9161	-	8938	-	8716	8497	7988	7415	6706	5853	-	-	-	-	-	-	-	-
			23.0	2.05	23.0	2.13	22.0	2.21	22.0	2.27	21.0	2.38	20.0	2.46	19.7	2.49	18.6	2.43	-	-
3	895	6502	9493	-	9278	-	9063	8851	8372	7840	7239	6421	5162	-	-	-	-	-	-	-
			25.0	2.26	24.0	2.35	24.0	2.43	23.0	2.50	22.0	2.61	22.0	2.70	21.0	2.75	20.0	2.73	18.4	2.56
3	921	6691	9782	-	9573	-	9364	9156	8702	8195	7624	6881	6055	-	-	-	-	-	-	-
			26.0	2.46	26.0	2.55	25.0	2.63	25.0	2.71	24.0	2.82	23.0	2.93	23.0	2.99	22.0	2.99	20.0	2.90
5	960	6974	10213	-	10013	-	9812	9612	9193	8720	8189	7568	6816	-	-	-	-	-	-	-
			28.0	2.78	27.0	2.87	27.0	2.96	26.0	3.04	25.0	3.17	25.0	3.28	24.0	3.36	24.0	3.40	22.0	3.36
5	1000	7265	10655	-	10463	-	10270	10078	9691	9239	8757	8221	7523	-	-	-	-	-	-	-
			30.0	3.14	29.0	3.23	29.0	3.32	28.0	3.41	27.0	3.55	26.0	3.67	26.0	3.77	25.0	3.83	24.0	3.83
5	1045	7592	11151	-	10967	-	10783	10599	10236	9814	9369	8875	8318	-	-	-	-	-	-	-
			31.0	3.57	31.0	3.66	31.0	3.76	30.0	3.85	29.0	4.01	28.0	4.14	28.0	4.26	27.0	4.34	26.0	4.39
5	1091	7926	11658	-	11482	-	11305	11129	10780	10395	9981	9531	9039	-	-	-	-	-	-	-
			34.0	4.05	33.0	4.15	33.0	4.25	33.0	4.35	31.0	4.53	31.0	4.66	30.0	4.80	29.0	4.91	29.0	4.96

Performance shown is for installation type A: Free Inlet, Free Outlet. Power rating (BHP) does not include drive losses. For further information on estimating belt drive losses and motor service factors see page 12. The sound ratings shown are for loudness values in fan sones at 5'0" (1.5m) in a hemispherical free field per AMCA Standard 301. Values shown are for installation Type A: free inlet hemispherical sone levels. Performance ratings do not include the effects of appurtenances in the airstream.

©PENNBARRY 2014

FX30B | BELT DRIVE

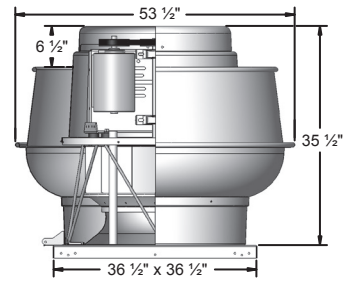
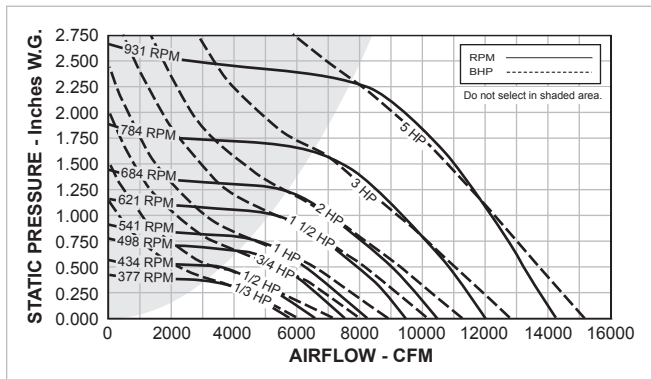

Galv. Steel Base = 14 Gage	Roof Opening = 28" SQ.	Peak BHP = (RPM/539) ³
Aluminum Base = 0.080	Damper Size = 27 3/4" SQ.	Max. RPM = 1188 (5 HP)
Discharge Apron = 0.080	Max. Motor Frame Size = 184T	Est. Ship Weight = 219 lbs.*

* Add 65 lbs. for Heat & Smoke option.

HP	RPM	Tip Speed FPM	0.000" SP		0.250" SP		0.500" SP		0.750" SP		1.000" SP		1.250" SP		1.500" SP		1.750" SP		2.000" SP		2.250" SP		
			Sones	BHP	Sones	BHP	Sones	BHP	Sones	BHP	Sones	BHP	Sones	BHP	Sones	BHP	Sones	BHP	Sones	BHP	Sones	BHP	Sones
1/3	347	2782	5314	3779	-	-	-	-	-	-	-	-	-	-	-	-	-	-	-	-	-	-	-
	377	3023	5773	4431	-	-	-	-	-	-	-	-	-	-	-	-	-	-	-	-	-	-	-
1/2	400	3207	6125	4899	-	-	-	-	-	-	-	-	-	-	-	-	-	-	-	-	-	-	-
	420	3367	6431	5283	-	-	-	-	-	-	-	-	-	-	-	-	-	-	-	-	-	-	-
3/4	434	3480	6646	5548	3742	-	-	-	-	-	-	-	-	-	-	-	-	-	-	-	-	-	-
	455	3648	6968	5937	4445	-	-	-	-	-	-	-	-	-	-	-	-	-	-	-	-	-	-
1	480	3848	7350	6377	5078	-	-	-	-	-	-	-	-	-	-	-	-	-	-	-	-	-	-
	498	3993	7626	6690	5505	-	-	-	-	-	-	-	-	-	-	-	-	-	-	-	-	-	-
1 1/2	520	4169	7963	7069	5984	-	-	-	-	-	-	-	-	-	-	-	-	-	-	-	-	-	-
	541	4338	8285	7428	6433	4939	-	-	-	-	-	-	-	-	-	-	-	-	-	-	-	-	-
2	560	4490	8576	7748	6818	5514	-	-	-	-	-	-	-	-	-	-	-	-	-	-	-	-	-
	595	4770	9112	8333	7491	6397	-	-	-	-	-	-	-	-	-	-	-	-	-	-	-	-	-
3	621	4979	9510	8764	7983	6985	5581	-	-	-	-	-	-	-	-	-	-	-	-	-	-	-	-
	640	5131	9801	9077	8335	7397	6193	-	-	-	-	-	-	-	-	-	-	-	-	-	-	-	-
4	665	5332	10184	9488	8776	7930	6835	-	-	-	-	-	-	-	-	-	-	-	-	-	-	-	-
	684	5484	10474	9798	9109	8314	7311	5817	-	-	-	-	-	-	-	-	-	-	-	-	-	-	-
5	710	5693	10873	10221	9560	8817	7911	6748	-	-	-	-	-	-	-	-	-	-	-	-	-	-	-
	730	5853	11179	10545	9905	9199	8347	7299	-	-	-	-	-	-	-	-	-	-	-	-	-	-	-
6	750	6013	11485	10869	10248	9578	8777	7806	6405	-	-	-	-	-	-	-	-	-	-	-	-	-	-
	770	6174	11792	11191	10588	9953	9202	8305	7144	-	-	-	-	-	-	-	-	-	-	-	-	-	-
7	784	6286	12006	11416	10824	10211	9487	8630	7591	-	-	-	-	-	-	-	-	-	-	-	-	-	-
	805	6454	12328	11753	11177	10582	9895	9090	8132	-	-	-	-	-	-	-	-	-	-	-	-	-	-
8	840	6735	12863	12313	11761	11196	10566	9844	9011	7982	-	-	-	-	-	-	-	-	-	-	-	-	-
	880	7055	13476	12951	12424	11889	11322	10674	9918	9049	7955	-	-	-	-	-	-	-	-	-	-	-	-
9	915	7336	14012	13507	13000	12491	11963	11351	10673	9923	9018	7663	-	-	-	-	-	-	-	-	-	-	-
	931	7464	14257	13760	13263	12764	12245	11658	11015	10285	9427	8352	-	-	-	-	-	-	-	-	-	-	-
			34.0	4.17	34.0	4.35	32.0	4.54	31.0	4.75	30.0	4.87	29.0	5.00	28.0	5.11	27.0	5.17	25.0	5.18	24.0	5.11	-

Performance shown is for installation type A: Free Inlet, Free Outlet. Power rating (BHP) does not include drive losses. For further information on estimating belt drive losses and motor service factors see page 12. The sound ratings shown are for loudness values in fan sones at 5'0" (1.5m) in a hemispherical free field per AMCA Standard 301. Values shown are for installation Type A: free inlet hemispherical sone levels. Performance ratings do not include the effects of appurtenances in the airstream.

FX36B | BELT DRIVE

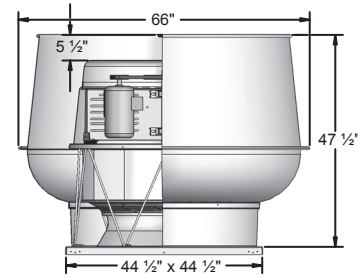
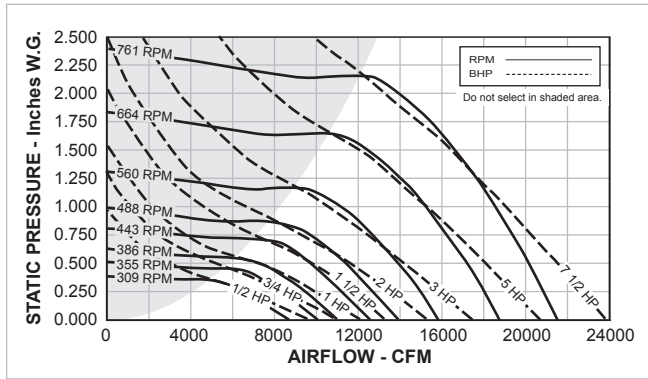

Galv. Steel Base = 12 Gage	Roof Opening = 36" SQ.	Peak BHP = (RPM/384) ³
Aluminum Base = 0.102	Damper Size = 35 1/2" SQ.	Max. RPM = 810 (7 1/2 HP)
Discharge Apron = 0.080	Max. Motor Frame Size = 213T	Est. Ship Weight = 470 lbs.*

* Add 110 lbs. for Heat & Smoke option.

HP	RPM	Tip Speed FPM	0.000" SP		0.250" SP		0.500" SP		0.750" SP		1.000" SP		1.250" SP		1.375" SP		1.500" SP		1.750" SP		2.000" SP		
			Sones	BHP	Sones	BHP	Sones	BHP	Sones	BHP	Sones	BHP	Sones	BHP	Sones	BHP	Sones	BHP	Sones	BHP	Sones	BHP	Sones
1/2	269	2619	7603	4897	-	-	-	-	-	-	-	-	-	-	-	-	-	-	-	-	-	-	-
	309	3008	8734	6761	-	-	-	-	-	-	-	-	-	-	-	-	-	-	-	-	-	-	-
3/4	335	3261	9469	7715	-	-	-	-	-	-	-	-	-	-	-	-	-	-	-	-	-	-	-
	355	3456	10034	8409	-	-	-	-	-	-	-	-	-	-	-	-	-	-	-	-	-	-	-
1	370	3602	10458	8912	6306	-	-	-	-	-	-	-	-	-	-	-	-	-	-	-	-	-	-
	386	3758	10911	9441	7253	-	-	-	-	-	-	-	-	-	-	-	-	-	-	-	-	-	-
1 1/2	405	3943	11448	10054	8198	-	-	-	-	-	-	-	-	-	-	-	-	-	-	-	-	-	-
	420	4089	11872	10531	8875	-	-	-	-	-	-	-	-	-	-	-	-	-	-	-	-	-	-
2	465	4527	13144	11941	10593	8429	-	-	-	-	-	-	-	-	-	-	-	-	-	-	-	-	-
	488	4751	13794	12653	11417	9673	-	-	-	-	-	-	-	-	-	-	-	-	-	-	-	-	-
3	500	4868	14133	13022	11823	10221	-	-	-	-	-	-	-	-	-	-	-	-	-	-	-	-	-
	515	5014	14557	13483	12327	10896	8139	-	-	-	-	-	-	-	-	-	-	-	-	-	-	-	-
5	530	5160	14981	13942	12827	11516	9322	-	-	-	-	-	-	-	-	-	-	-	-	-	-	-	-
	550	5355	15547	14552	13488	12259	10497	-	-	-	-	-	-	-	-	-	-	-	-	-	-	-	-
7 1/2	560	5452	15829	14855	13810	12627	11008	-	-	-	-	-	-	-	-	-	-	-	-	-	-	-	-
	580	5647	16395	15460	14449	13354	11922	9624	-	-	-	-	-	-	-	-	-	-	-	-	-	-	-
7	600	5841	16960	16063	15084	14062	12820	10863	-	-	-	-	-	-	-	-	-	-	-	-	-	-	-
	620	6036	17525	16663	15713	14738	13596	12025	10842	-	-	-	-	-	-	-	-	-	-	-	-	-	-
7 1/2	640	6231	18091	17262	16339	15407	14337	12945	12022	10872	-	-	-	-	-	-	-	-	-	-	-	-	-
	664	6464	18769	17978	17086	16203	15213	14029	13246	12296	-	-	-	-	-	-	-	-	-	-	-	-	-
7 1/2	680	6620	19221	18453	17581	16726	15791	14708	13975	13211	-	-	-	-	-	-	-	-	-	-	-	-	-
	700	6815	19787	19047	18197	17367	16481	15455	14874	14131	12265	-	-	-	-	-	-	-	-	-	-	-	-
7 1/2	720	7010	20352	19639	18813	18003	17155	16193	15681	15037	13445	-	-	-	-	-	-	-	-	-	-	-	-
	745	7253	21059	20372	19579	18794	17990	17104	16610	16116	14756	12913	-	-	-	-	-	-	-	-	-	-	-
7 1/2	761	7409	21511	20839	20067	19297	18520	17681	17198	16714	15488	13862	-	-	-	-	-	-	-	-	-	-	-
			32.0	5.58	32.0	6.17	31.0	6.42	29.0	6.73	28.0	7.08	27.0	7.40	26.0	7.53	26.0	7.66	25.0	7.77	24.0	7.71	-

Performance shown is for installation type A: Free Inlet, Free Outlet. Power rating (BHP) does not include drive losses. For further information on estimating belt drive losses and motor service factors see page 12. The sound ratings shown are for loudness values in fan sones at 5'0" (1.5m) in a hemispherical free field per AMCA Standard 301. Values shown are for installation Type A: free inlet hemispherical sone levels. Performance ratings do not include the effects of appurtenances in the airstream.

FMX50B | BELT DRIVE

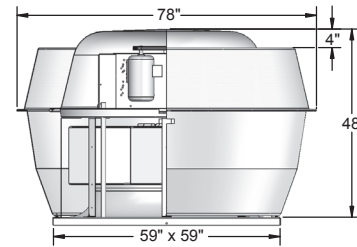
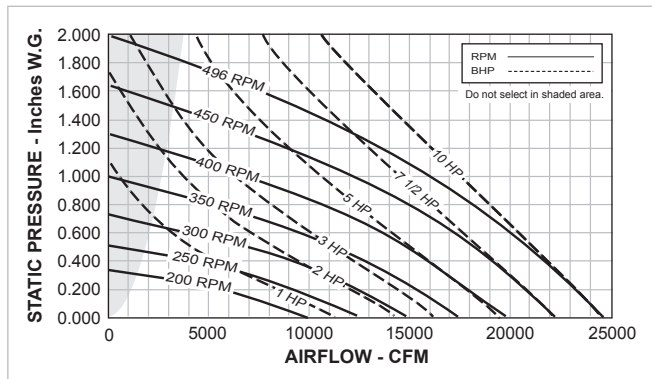

Galv. Steel Base = 12 Gage	Roof/Wall Opening = 50" SQ.	Peak BHP = (RPM/218) ³
Aluminum Base = 0.125	Damper Size = 49 1/2" SQ.	Max. RPM = 496 (10 HP)
Discharge Apron = 0.125	Max. Motor Frame Size = 215T	Est. Ship Weight = 928 lbs.

HP	RPM	Tip Speed FPM	0.000		0.125		0.250		0.375		0.500		0.625		0.750		1.000		1.250		1.500														
			Sones	BHP	Sones	BHP	Sones	BHP	Sones	BHP	Sones	BHP	Sones	BHP	Sones	BHP	Sones	BHP	Sones	BHP	Sones	BHP													
3/4	190	2487	9590		6496		-		-		-		-		-		-		-		-														
			6.8	0.58	6.5	0.50	-		-		-		-		-		-		-		-														
1	220	2880	11104		8594		5052		-		-		-		-		-		-		-														
			8.2	0.90	8.0	0.82	7.8		0.65		-		-		-		-		-		-														
1 1/2	240	3142	12114		9844		6952		2496		-		-		-		-		-		-														
			9.0	1.17	8.9	1.09	8.6		0.94		-		-		-		-		-		-														
2	265	3469	13376		11332		8913		5705		-		-		-		-		-		-														
			9.6	1.57	10.0	1.48	9.5		1.35		-		-		-		-		-		-														
3	300	3927	15142		13343		11401		9007		5907		-		-		-		-		-														
			10.3	2.28	11.6	2.18	11.1		2.07		10.3		1.86		-		-		-		-														
5	350	4581	17666		16127		14558		12761		10689		8219		5128		-		-		-														
			12.6	3.62	14.6	3.50	14.2		3.39		13.5		3.22		12.6		2.97		12.6		2.65		12.6		2.17										
7.5	400	5236	20189		18846		17489		16096		14446		12643		10643		5311		-		-														
			14.6	5.41	16.2	5.27	17.0		5.14		16.4		5.01		15.7		4.79		14.6		4.50		14.6		4.17		14.6		3.12						
10	450	5890	22713		21519		20316		19098		17855		16346		14767		11171		6364		-														
			16.0	7.70	19.5	7.54	19.7		7.39		19.2		7.25		18.6		7.10		17.7		6.83		16.5		6.53		16.0		5.76		16.0		4.56		
10	496	6493	25035		23951		22864		21768		20650		19490		18119		15199		11733		7381														
			17.3	10.3	22.6	10.14	22.2		9.97		21.7		9.81		21.1		9.65		20.5		9.47		19.6		9.17		17.3		8.46		17.3		7.57		17.3

Performance shown is for installation type A: Free Inlet, Free Outlet. Power rating (BHP) does not include drive losses. For further information on estimating belt drive losses and motor service factors see page 12. The sound ratings shown are for loudness values in fan sones at 5'0" (1.5m) in a hemispherical free field per AMCA Standard 301. Values shown are for installation Type A: free inlet hemispherical sone levels. Performance ratings do not include the effects of appurtenances in the airstream.

ENGINEERING SPECIFICATIONS

Model

FX = Centrifugal Fan
 WFX = Wall Mounted Centrifugal Fan
 FMX = High Capacity Centrifugal Fan

Unit Size

08, 10, 11, 12, 13, 14, 16,
 18, 24, 27, 30, 36, 50

Drive Type

D = Direct Drive
 B = Belt Drive

Motor Tap

Q = 1725 RPM
 R = 1550 RPM
 S = 1300 RPM
 V = 1050 RPM
 Q1 = 1650 RPM
 Q2 = 1725 RPM

Motor Speed

1 = Single Speed
 2 = 2S2W Single & Three Phase
 3 = 2S1W Three Phase

Horse Power

1/50	1/12	1/5	3/4	3
1/30	1/11	1/4	1	5
1/25	1/7	1/3	1 1/2	7 1/2
1/20	1/6	1/2	2	10

Enclosure

O = Open Drip Proof
 T = Totally Enclosed
 E = Explosion Proof
 X = Special

Voltage

A = 110V	G = 230V	N = 440V
B = 115V	H = 240V	P = 460V
C = 120V	J = 277V	Q = 480V
D = 200V	K = 380V	R = 575V
E = 208V	L = 400V	S = 600V
F = 220V	M = 415V	X = Special

Phase

1 = Single
 3 = Three

Cycle

5 = 50 Hz
 6 = 60 Hz

Efficiency

S = Standard
 H = High Efficiency

Paint / Coating

0 = None
 F = Epoxy Powder Coat*
 G = Epoxy Powder Coat with UV*
 H = Hi-Temp Powder Coat*
 J = Non-stick Powder Coat*
 K = Phenolic Powder Coat*
 L = Phenolic Powder Coat with UV*
 N = Polyester Powder Coat
 X = Special
 * Not available with choice of color.

Color

0 = None
 50 = Chrome Green
 53 = Williamsburg Blue
 55 = Pale Green
 56 = Dove Gray
 61 = White
 63 = Oxford Beige
 65 = Dover White
 66 = Desert Tan
 70 = Black
 73 = Smoke Gray
 77 = Brick Red
 79 = Peppercorn
 81 = Pale Brown
 83 = Chocolate Brown
 85 = Timeless Bronze
 94 = Charcoal
 X = Special

AMCA Spark Rating

0 = None
 C = Standard
 B = Optional

Damper

0 = None
 BDD = Gravity Back Draft Damper
 MD1 = Gravity Back Draft Damper 115V
 MD2 = Gravity Back Draft Damper 230V
 MD4 = Gravity Back Draft Damper 460V
 ED1 = Explosion Proof Motor Operated Damper 115V

Screen

0 = None
 B = Bird Screen
 S = Insect/Bird Screen

Roof Curb

0 = None	K = UCA18	V = UG18
A = UCG8	L = UG12	W = URA12
B = UCG12	M = SA16	Y = URA18
C = UCG18	N = SFG12	1 = URG12
D = UCA8	P = SFG18	10 = SFA8
E = UCA12	Q = SG16	11 = USCG
F = SFA12	R = SRA16	12 = USCA
G = SFA18	S = SRG16	2 = URG18
H = SCG16	T = UA12	4 = UVA18
J = SCA16	U = UA18	5 = UVG18

Slope

0 = None
 S = Single
 D = Double

Metal Liner

0 = None
 L = Metal Liner

Damper Holding Plate

0 = None
 P = Damper Holding Plate

Neoprene Gasket

0 = None
 G = Gasket

No Wooden Nailer

0 = None
 N = No Wooden Nailer

Curb Paint/Coating

B = Air Dried Epoxy
 Q = Enamel

Hinged Sub-base

0 = None
 H = Hinged Sub-base

Mounting Pedestal

0 = None
 P = Mounting Pedestal

Floating Hinge Kit

0 = None
 H = Floating Hinge Kit

Aluminum Base

0 = None
 A = Aluminum Base

Thermal Overload Protection

0 = None
 P = Thermal Overload Protection

Disconnect Switch

0 = None
 1 = NEMA 1 Disconnect Switch
 3R = NEMA 3R Disconnect Switch
 4 = NEMA 4 Disconnect Switch
 7 = NEMA 7 Disconnect Switch
 9 = NEMA 9 Disconnect Switch

Internal Wiring

0 = None
 1 = NEMA 1 Internal Wiring
 3R = NEMA 3R Internal Wiring

Continued, next page.

ENGINEERING SPECIFICATIONS

Transformer

0 = None
T = Transformer

Speed Controller

0 = None
L = Loose
M = Mounted

Firestat Switch

0 = None
F = Firestat Switch

Fatrap

0 = None
F = Fatrap

Heat & Smoke Removal

0 = None
-HS = Heat & Smoke Removal

Wall Mount

0 = None
W = Wall Mount

High Pressure Wheel

0 = None
H = High Pressure Wheel

High Wind Construction

0 = None
M = Miami Dade Approved

Fumex - Direct Drive Units

Direct drive centrifugal roof exhaust upblast fan shall be Fumex FX, manufactured by PennBarry, Plano, TX 75074. The housing shall be weatherproof, utilize heavy gauge spun aluminum construction with a large rolled bead for strength, with galvanized (aluminum optional) base, with rigid galvanized steel internal support structures. Housing shall not provide any of the internal structural support. Units shall be equipped with an oversized electrical conduit chase through the curb cap and into the motor compartment for ease of wiring (except Explosion Proof). Units shall be pre-wired to a junction box mounted in the motor compartment and equipped with an electrical disconnect device (except Explosion Proof).

Statically and dynamically balanced backward inclined, centrifugal wheels shall be aluminum, spark-resistant, nonoverloading, and matched to deeply spun venturis. Motors shall be continuous duty, permanently lubricated, multispeed (for applicable models), have thermal overload protection, mounted out of the main airstream, be easily accessible for service, and furnished at the specified voltage, phase and enclosure. Each fan shall bear the AMCA Certified Ratings Seal for Air and Sound Performance, and shall be UL (UL Std. 705, UL Std. 762 optional applicable models) and CSA listed. If specified (Fatrap option), fan shall additionally provide UL 762 Listing rated at 400°F, motor pre-wired to a weather-proof junction box, and drain connection leading into a grease collector/separator box.

Fumex - Belt Drive Units

Belt drive centrifugal roof exhaust upblast fan shall be Fumex FX/FMX, manufactured by PennBarry, Plano, TX 75074. The housing shall be weatherproof, utilize heavy-gauge spun aluminum construction with a large rolled bead for strength, with galvanized (aluminum optional except FMX) base, with rigid galvanized steel internal support structures. Housing shall not provide any of the internal structural support. Large diameter cooling tube shall provide ambient air to flow over motor. Units shall be equipped with an oversized electrical conduit chase through the curb cap and into the motor compartment for ease of wiring (except Explosion Proof). Units shall be prewired to a junction box mounted in the motor compartment and equipped with an electrical disconnect device (except Explosion Proof).

Statically and dynamically balanced backward inclined, centrifugal wheels shall be aluminum, spark-resistant, nonoverloading, and be matched to deeply spun venturis. Motors shall be continuous duty, ball bearing design, permanently lubricated, mounted out of the main airstream, and furnished at the specified voltage, phase, and enclosure. Shafts shall be turned, ground and polished. Heavy duty ball bearings are rated for a minimum L50 life exceeding 200,000 hours. Pulleys shall be adjustable, cast iron, machined, keyed, securely attached, and sized for 150% of the horsepower at its rated maximum speed. Each fan shall bear the AMCA Certified Ratings Seal for Air and Sound Performance (FX) or for Air performance (FMX), and shall be UL (UL Std. 705, UL Std. 762 optional) and CSA listed. If specified (Fatrap option), fan shall additionally provide UL 762 Listing rated at 400°F. (300°F FMX), motor pre-wired to a weather-proof junction box, and drain connection leading into a grease collector/separator box. If specified (heat and smoke removal option), fan shall additionally provide UL listing rated for 500°F at 4-hours and 1000°F at 1 hour, including steel wheel and additional cooling tube.



PennBarry Product Solutions

COMMERCIAL

Roof & Wall Exhaust Centrifugal Fans
Ceiling, Wall, & Inline Centrifugal Fans
Roof Supply Centrifugal Fans
Square & Round Centrifugal Fans
Wall Mounted Axial Fans
Hooded Roof Axial Fans
Upblast Roof Axial Fans
Gravity Ventilators
Roof Curbs

INDUSTRIAL

Utility Vent Sets
Freestanding Centrifugal Fans
Industrial & Material Handling Fans
Tubular Centrifugal Inline Fans
Mixed Flow Centrifugal Fans
Plug & Plenum Fans
Wall Mounted Propeller Fans
Tube Axial Fans
Vane Axial Fans
Bifurcator Fans
Fume Exhaust

ENERGY RECOVERY

Outdoor Units
Indoor Units

KITCHEN VENTILATION

Kitchen Hoods
Make-Up Air Units
Exhaust Fans



PENN BARRY™

Moving Your Way

PennBarry is proud to be your preferred manufacturer of commercial and industrial fans and blowers. Learn how PennBarry can assist you in your next application by contacting your PennBarry Representative or visiting us on the web at www.pennbarry.com.

PennBarry | www.pennbarry.com | pennbarrysales@pennbarry.com | tel: 972.212.4700 | fax: 972.212.4702

PennBarry reserves the right to make changes at any time, without notice, to models, construction, specifications, options, availability, etc. This bulletin illustrates the appearance of PennBarry products at the time of publication. View the latest updates on the PennBarry website.