

COLORGARD®



Snow retention systems

from **S-5!**TM



Fortunately no one was using the pedestrian walk at above left when this avalanche occurred.



The icicles at center are about to break the front windows when this bank of snow slides farther.



The snow above this entry door could release at any moment.



At left an unsuspecting pedestrian enters as another customer loads his truck beneath the roof eave. Moments later (right) both would have been hit by 40 or 50 pounds of snow.



Snow sliding or falling from rooftops can be dangerous to vehicular and pedestrian traffic. Snow can easily weigh 15 pounds per cubic foot or more. A 20-foot by 40-foot roof with an 18-inch deep blanket of snow suddenly avalanching can send as much as ten tons of snow crashing onto whatever is beneath it. It can tear off eave gutters and damage other building elements, as well.



Here, entries, drive-ups and eave gutters are protected by S-5! COLORGARD, so that snow evacuates slowly (by thaw) rather than suddenly and unexpectedly.



When snow is on the roof, S-5! COLORGARD is hidden beneath the blanket of snow, getting the job done!



When the snow is gone, the clean lines and unobtrusive appearance of COLORGARD blend right into the roofscape.



WHY KEEP SNOW ON THE ROOF?

• When snow avalanches from a rooftop it can damage anything in its path!

When snow is falling, it forms a temperature-sensitive bond to the surface of the roof. As the roof surface is warmed from either building heat loss or the sun's radiant energy, this bond is broken, and a thin film of melt water lubricates the surface of the roof. The result can be rather dramatic, as the entire blanket of snow vacates the roof suddenly— in avalanche fashion, dumping tons of snow onto anything in its path. It can damage landscape, gutters, adjacent roofs, vehicles, and can even pose a threat to personal safety. The snowbank which is then piled up below the eave of the roof can cause other problems, like damage to the building walls, or directing melt water *into* rather than *away* from the wall. Some architectural designs provide for the anticipated evacuation of snow from the roof surface, but often this is not possible or practical. In such cases, snow retention devices are often used to allow the snow to slowly evacuate (in small bits, or as meltwater), rather than suddenly (via avalanche).

WHY COLORGARD®?

• For perfect color matching— that lasts for the life of the roof!

We know that there is an ever-increasing list of snow retention products and manufacturers from which to choose. Each claiming to be the best, the first, the "ultimate", the "leader", the premier choice. It can be difficult to sort facts from sales rhetoric. How does COLORGARD differ from *all* others? COLORGARD is the *only* product available that will perfectly match the roof color— for the entire life of the roof.

Premium paint finishes used on metal panels are "coil-coated". This is a method of paint application that utilizes state-of-the-art technologies, chemical pretreatment, primer and finish coat application, and controlled oven curing. This is the only method by which high quality Kynar and Hylar (PVDF) paint systems can be applied and warranted against color fade for 20 years and longer.

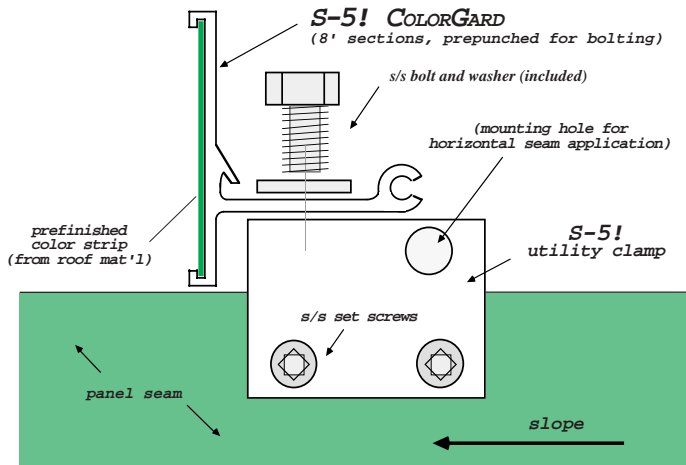

Everything imaginable has been attempted to equal the performance level of factory coil-coating methods— nothing can. Not anodizing, not powder coating, not any kind of dye or any kind of air-dried paint. Snow guard manufacturers utilize all these methods to color match products to the roof material. The paint perfectly matches when new, but in a few years, the inferior application on the snowguard fades more than the roof— causing an unsightly effect. Even powder coating with Kynar resin cannot equal the performance of coil-coated Kynar.

COLORGARD is the only product which utilizes the same factory applied (coil-coated) finish as the roof itself. We do this by utilizing a strip of the actual roof material which is then mounted directly into COLORGARD to perfectly match the roof— forever!

HOW IS COLORGARD® ATTACHED?

• With patented S-5! clamping hardware- the trusted name in metal roof attachment technology, worldwide.

COLORGARD does not rely upon adhesives for attachment to the roof panel. Why does that matter? The premium finishes used on today's metal roof products are fluorocarbons— "Hylar" and "Kynar" by tradename. These paint resins (polyvinylidene difluoride or PVDF) are similar in chemical composition to "Teflon", the popular nonstick coating for pots and pans. Indeed, the benefits of this type paint are related to its nonstick characteristics. Gluing a device to a nonstick surface results with rather unreliable performance and high failure rates. Most adhesives are temperature cure compounds, which means that they can only be applied in warm weather and require weeks to cure, limiting their installation seasonally.

WHY S-5!™?

- No unreliable adhesives
- No panel penetration
- S-5! does not violate panels' thermal movement
- Unequalled holding strength
- No premature corrosion
- S-5! attachment does not violate roof system warranties
- Recommended by all leading metal building and metal panel manufacturers

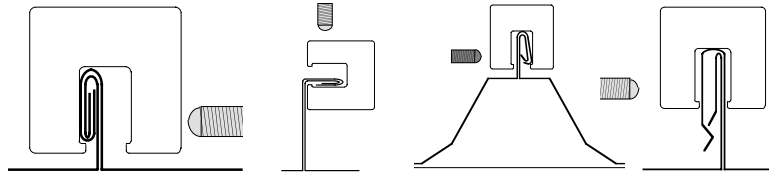
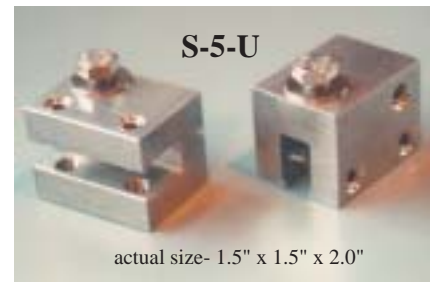

S-5! clamps are available for virtually any panel profile on the market-- architectural and metal building panels



S-5! clamp technology involves gripping the seam in such a way that there is no penetration to the panel material. We utilize patented, round-point set screws for attachment which are specially made only for the S-5! system. S-5! never uses "cup point" screws like all the copycats. Such a screw point cuts through the paint and protective coating of standing seam panels, causing corrosion and voiding warranties. We have done 1000 hour ASTM B-117 Salt Fog testing of our attachment, to be sure that it causes NO CORROSION on painted Galvalume or galvanized panels. All related S-5! hardware is noncorrosive 300 series stainless, not plated steel.

The tenacity of the S-5! method of attachment is thoroughly tested and unequalled by other products. Holding strength of S-5! varies on different seam profiles, material types and gages— and we have tested our products on all those different panel seams, doing hundreds of independent laboratory pull tests. What does all this prove? It proves the holding strength of the S-5! clamp is absolutely unsurpassed. Ultimate load-to-failure of S-5! averages over 1,800 pounds—with values in some cases over 4,000 pounds! This kind of strength is up to ten times stronger than alternative products.

WHAT ABOUT INSTALLATION?

- COLORGARD installs at 20 to 35 ft./man-hour
- It's simple- it was designed by a contractor
- COLORGARD can be installed any time of year
- COLORGARD installs with ordinary tools



1. install clamps

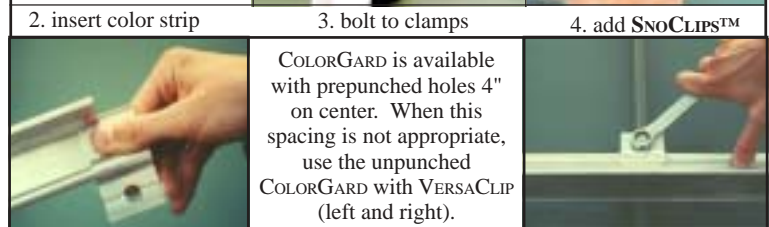

The whole installation took... half the time of other products. The price was about 20% less expensive than the unreliable plastic 'glue-on' type. Best of all, the customer was very pleased with the installation. ...We highly recommend [COLORGARD] to all of our customers with snow slide problems.

-Walter Cross, Interspec Construction

[COLORGARD] installs quickly and easily, looks good, and doesn't come off like [other products]. We prefer the S-5! systems over any others... in my opinion they are simply the best available.

-Jeremiah Snow, Charles F. Evans Company

...Western New York and Northern Pennsylvania will prove or disprove any manufacturer's claims about snowguards. ...ColorGard is one case where those claims are actually understated. It's the only system that lets me sleep well at night. No holes, no glue and unbelievable holding strength. ...ColorGard is the perfect solution with its versatile design, prepunched holes, strength of attachment, and unique accessories like the SnoClip. At production rates of over 35 feet per man-hour it's also profitable to install. And it's actually cheaper than all the products that don't work. This stuff is almost too good to be true.

-Karl Wittie, KW Industries

We use ColorGard regularly because of the ease of installation... and it can be installed in all types of weather. It keeps my crews working and helps meet my schedules.

-Pat Sweeney, Innovative Building Concepts

Performance is key when installing a snow slide protection system. That's why Dutton & Garfield recommends the S-5! COLORGARD system. COLORGARD is a quality system that holds up to the elements, with easy installation, at a competitive price... We look forward to installing another mile of COLORGARD.

-Keith A. Wentworth, Dutton & Garfield

100% noncorrosive components, perfect and permanent color matching, ease of use and installation, superior holding strength— these are the reasons we claim that...

THE VANGUARD OF SNOWGUARDS IS **S-5! COLORGARD®**

Galvalume is a trademark of BIEC International. Kynar and Kynar 500 are trademarks of Atofina. Hylar and Hylar 5000 are trademarks of Ausimont, USA. Teflon is a trademark of E.I. Dupont de NeMours. S-5, S-5!, VersaClip, SnoClip, VersaBracket are trademarks of Metal Roof Innovations, Ltd. (MRIL). ColorGard is a registered trademark of Metal Roof Innovations, Ltd (MRIL). ColorGard and other S-5 products are protected by one or more of the following US patents:

5,228,248 5,483,772 5,491,931 5,694,721 5,715,640 5,983,588 6,164,033

Other U.S. and foreign patents are pending.

